

Congestion Management Plan Update
Montgomery MPO

PC-Travel Reports for study: Taylor Rd PM SB Study

<u>Report Name</u>	<u>Page</u>
Study Summary	2
Overall Output Statistics	3
Detailed Statistics By Run - Travel Times	4
Detailed Statistics By Run - Average Speed	5
Detailed Statistics By Run - Total Delay	6
Detailed Statistics By Run - Time <= 0 MPH	7
Detailed Statistics By Run - Time <= 30 MPH	8
Detailed Statistics By Run - Time <= 45 MPH	9
Speed/Distance Profiles of All Runs	10

Congestion Management Plan Update

Montgomery MPO

Study Name : **Taylor Rd PM SB Study**
 Study Date : **10/28/2013**
 Page No. : **2**

Study Summary

Runs Used in This Study

Run Title	Start Date	Start Time	Length	Before/ After	Run Type
Taylor Rd PM-SB-001 t	10/28/13	17:50	17162	Before	Secondary
Taylor Rd PM-SB-002 t	10/29/13	17:46	17189	Before	Secondary
Taylor Rd PM-SB-003 t	11/04/13	16:14	17179	Before	Secondary

Notes:

Node Info

#	Len	Name
1	0	Atlanta Hwy
2	904	Winton Blount Loop
3	757	Winton Blount Loop
4	1026	Copperfield Dr
5	783	Sydney Curve
6	1543	University Ct
7	541	East Dr / Halcyon
8	1096	Wadsworth Way /
9	762	I-85 WB Ramps
10	496	I-85
11	563	I-85 EB Ramps
12	1049	Eastchase Pkwy
13	531	Halcyon Forest Trl
14	496	Berryhill Rd
15	852	Barnett Rd / Halcyon
16	1901	Taylor Cir
17	303	Prairie Ln
18	75	Taylor Cir
19	518	Taylor Ct
20	207	Meriwether Cir
21	387	Eastwood Glen Dr /
22	840	Chappelle Ln
23	758	Taylor Park Rd
24	790	Vaughn Rd

Length of Study Route = 17,178 feet

Congestion Management Plan Update

Montgomery MPO

Study Name : Taylor Rd PM SB Study

Study Date : 10/28/2013

Page No. : 3

Overall Output Statistics

Node #	Length	Node	Travel Time	# of Stops	Avg Speed	Total Delay	Time <= 0 MPH	Time <= 30 MPH	Time <= 45 MPH
1	0	Atlanta Hwy							
2	904	Winton Blount Loop	24.0	0.0	25.7	8.0	0.0	15.3	24.0
3	757	Winton Blount Loop	20.7	0.3	25.0	7.3	1.7	9.3	20.7
4	1026	Copperfield Dr	20.0	0.0	35.0	2.0	0.0	1.0	20.0
5	783	Sydney Curve	14.0	0.0	38.1	0.3	0.0	0.0	14.0
6	1543	University Ct	27.0	0.0	39.0	0.3	0.0	1.0	27.0
7	541	East Dr / Halcyon Summit Dr	17.7	0.3	20.9	9.0	3.7	11.7	17.7
8	1096	Wadsworth Way / Halcyon	17.0	0.0	44.0	0.7	0.0	0.0	10.3
9	762	I-85 WB Ramps	11.7	0.0	44.5	0.0	0.0	0.0	8.0
10	496	I-85	7.7	0.0	44.1	0.0	0.0	0.0	5.7
11	563	I-85 EB Ramps	16.3	0.3	23.5	7.3	2.0	7.7	16.3
12	1049	Eastchase Pkwy	17.7	0.0	40.5	1.7	0.0	1.7	14.0
13	531	Halcyon Forest Trl	8.0	0.0	45.3	0.0	0.0	0.0	3.7
14	496	Berryhill Rd	8.0	0.0	42.3	0.0	0.0	0.0	5.3
15	852	Barnett Rd / Halcyon Blvd	12.3	0.0	47.1	0.3	0.0	0.0	5.3
16	1901	Taylor Cir	26.0	0.0	49.9	0.0	0.0	0.0	3.0
17	303	Prairie Ln	4.3	0.0	47.7	0.0	0.0	0.0	1.7
18	75	Taylor Cir	1.0	0.0	51.1	0.0	0.0	0.0	0.3
19	518	Taylor Ct	8.0	0.0	44.1	0.0	0.0	0.0	3.3
20	207	Meriwether Cir	3.3	0.0	42.3	0.3	0.0	0.7	3.3
21	387	Eastwood Glen Dr / Halcyon	7.3	0.0	36.0	1.3	0.0	1.3	7.3
22	840	Chappelle Ln	13.0	0.0	44.1	2.3	0.0	0.0	8.3
23	758	Taylor Park Rd	12.7	0.0	40.8	3.0	0.0	0.0	12.3
24	790	Vaughn Rd	123.7	1.0	4.4	113.7	66.7	118.0	123.3
Total	17,178		421.3	2.0	27.8	157.7	74.0	167.7	355.0

Stats based on 3 BEFORE runs.

Stops based on a Stop Speed of 5 MPH.

Congestion Management Plan Update

Montgomery MPO

Study Name : **Taylor Rd PM SB Study**
 Study Date : **10/28/2013**
 Page No. : **4**

Detailed Statistics By Run

Travel Time (sec) by Section

Taylor Rd PM-SB-001 t
 Taylor Rd PM-SB-002 t
 Taylor Rd PM-SB-003 t

Node #	Length	Node Name	Run #1	Run #2	Run #3
1	0	Atlanta Hwy			
2	904	Winton Blount Loop	26	22	24
3	757	Winton Blount Loop	32	15	15
4	1026	Copperfield Dr	21	19	20
5	783	Sydney Curve	13	15	14
6	1543	University Ct	26	28	27
7	541	East Dr / Halcyon	8	9	36
8	1096	Wadsworth Way /	16	16	19
9	762	I-85 WB Ramps	11	12	12
10	496	I-85	7	8	8
11	563	I-85 EB Ramps	9	29	11
12	1049	Eastchase Pkwy	16	20	17
13	531	Halcyon Forest Trl	7	9	8
14	496	Berryhill Rd	8	8	8
15	852	Barnett Rd / Halcyon Blvd	11	14	12
16	1901	Taylor Cir	25	28	25
17	303	Prairie Ln	4	5	4
18	75	Taylor Cir	1	1	1
19	518	Taylor Ct	8	8	8
20	207	Meriwether Cir	4	3	3
21	387	Eastwood Glen Dr /	9	6	7
22	840	Chappelle Ln	14	12	13
23	758	Taylor Park Rd	13	12	13
24	790	Vaughn Rd	113	154	104
Totals	17178		402	453	409

Congestion Management Plan Update

Montgomery MPO

Study Name : **Taylor Rd PM SB Study**
 Study Date : **10/28/2013**
 Page No. : **5**

Detailed Statistics By Run

Average Speed (MPH) by Section

Taylor Rd PM-SB-001 t
 Taylor Rd PM-SB-002 t
 Taylor Rd PM-SB-003 t

Node #	Length	Node Name	Run #1	Run #2	Run #3
1	0	Atlanta Hwy			
2	904	Winton Blount Loop	24.8	28.9	26.5
3	757	Winton Blount Loop	15.5	35.1	33.7
4	1026	Copperfield Dr	33.6	35.9	35.1
5	783	Sydney Curve	41.1	36.3	38.4
6	1543	University Ct	41.3	37.9	38.9
7	541	East Dr / Halcyon	42.6	42.3	10.4
8	1096	Wadsworth Way /	47.2	45.1	40.3
9	762	I-85 WB Ramps	48.7	44.0	43.5
10	496	I-85	45.9	42.0	40.6
11	563	I-85 EB Ramps	42.9	12.9	35.1
12	1049	Eastchase Pkwy	46.0	35.5	41.8
13	531	Halcyon Forest Trl	46.6	44.1	45.5
14	496	Berryhill Rd	47.6	39.9	44.0
15	852	Barnett Rd / Halcyon Blvd	48.9	40.6	47.4
16	1901	Taylor Cir	52.6	47.1	51.5
17	303	Prairie Ln	50.0	43.0	50.0
18	75	Taylor Cir	50.0	43.0	50.0
19	518	Taylor Ct	46.4	44.8	48.1
20	207	Meriwether Cir	30.3	44.3	42.3
21	387	Eastwood Glen Dr /	30.6	44.0	37.7
22	840	Chappelle Ln	41.8	47.2	42.0
23	758	Taylor Park Rd	38.9	41.2	40.5
24	790	Vaughn Rd	4.6	3.6	5.2
Totals	17178		29.2	25.9	28.7

Congestion Management Plan Update

Montgomery MPO

Study Name : **Taylor Rd PM SB Study**
 Study Date : **10/28/2013**
 Page No. : **6**

Detailed Statistics By Run

Total Delay (sec) by Section

Taylor Rd PM-SB-001 t
 Taylor Rd PM-SB-002 t
 Taylor Rd PM-SB-003 t

Node #	Length	Node Name	Run #1	Run #2	Run #3
1	0	Atlanta Hwy			
2	904	Winton Blount Loop	10	6	8
3	757	Winton Blount Loop	19	1	2
4	1026	Copperfield Dr	3	1	2
5	783	Sydney Curve	0	1	0
6	1543	University Ct	0	1	0
7	541	East Dr / Halcyon	0	0	27
8	1096	Wadsworth Way /	0	0	2
9	762	I-85 WB Ramps	0	0	0
10	496	I-85	0	0	0
11	563	I-85 EB Ramps	0	20	2
12	1049	Eastchase Pkwy	0	4	1
13	531	Halcyon Forest Trl	0	0	0
14	496	Berryhill Rd	0	0	0
15	852	Barnett Rd / Halcyon Blvd	0	1	0
16	1901	Taylor Cir	0	0	0
17	303	Prairie Ln	0	0	0
18	75	Taylor Cir	0	0	0
19	518	Taylor Ct	0	0	0
20	207	Meriwether Cir	1	0	0
21	387	Eastwood Glen Dr /	3	0	1
22	840	Chappelle Ln	3	1	3
23	758	Taylor Park Rd	3	3	3
24	790	Vaughn Rd	103	144	94
Totals	17178		145	183	145

Congestion Management Plan Update

Montgomery MPO

Study Name : **Taylor Rd PM SB Study**
 Study Date : **10/28/2013**
 Page No. : **7**

Detailed Statistics By Run

Time <= 0 MPH by Section

Taylor Rd PM-SB-001 t
Taylor Rd PM-SB-002 t
Taylor Rd PM-SB-003 t

Node #	Length	Node Name	Run #1	Run #2	Run #3
1	0	Atlanta Hwy			
2	904	Winton Blount Loop	0	0	0
3	757	Winton Blount Loop	5	0	0
4	1026	Copperfield Dr	0	0	0
5	783	Sydney Curve	0	0	0
6	1543	University Ct	0	0	0
7	541	East Dr / Halcyon	0	0	11
8	1096	Wadsworth Way /	0	0	0
9	762	I-85 WB Ramps	0	0	0
10	496	I-85	0	0	0
11	563	I-85 EB Ramps	0	6	0
12	1049	Eastchase Pkwy	0	0	0
13	531	Halcyon Forest Trl	0	0	0
14	496	Berryhill Rd	0	0	0
15	852	Barnett Rd / Halcyon Blvd	0	0	0
16	1901	Taylor Cir	0	0	0
17	303	Prairie Ln	0	0	0
18	75	Taylor Cir	0	0	0
19	518	Taylor Ct	0	0	0
20	207	Meriwether Cir	0	0	0
21	387	Eastwood Glen Dr /	0	0	0
22	840	Chappelle Ln	0	0	0
23	758	Taylor Park Rd	0	0	0
24	790	Vaughn Rd	61	101	38
Totals	17178		66	107	49

Congestion Management Plan Update

Montgomery MPO

Study Name : **Taylor Rd PM SB Study**
 Study Date : **10/28/2013**
 Page No. : **8**

Detailed Statistics By Run

Time <= 30 MPH by Section

Taylor Rd PM-SB-001 t
Taylor Rd PM-SB-002 t
Taylor Rd PM-SB-003 t

Node #	Length	Node Name	Run #1	Run #2	Run #3
1	0	Atlanta Hwy			
2	904	Winton Blount Loop	21	9	16
3	757	Winton Blount Loop	28	0	0
4	1026	Copperfield Dr	3	0	0
5	783	Sydney Curve	0	0	0
6	1543	University Ct	0	0	3
7	541	East Dr / Halcyon	0	0	35
8	1096	Wadsworth Way /	0	0	0
9	762	I-85 WB Ramps	0	0	0
10	496	I-85	0	0	0
11	563	I-85 EB Ramps	0	23	0
12	1049	Eastchase Pkwy	0	5	0
13	531	Halcyon Forest Trl	0	0	0
14	496	Berryhill Rd	0	0	0
15	852	Barnett Rd / Halcyon Blvd	0	0	0
16	1901	Taylor Cir	0	0	0
17	303	Prairie Ln	0	0	0
18	75	Taylor Cir	0	0	0
19	518	Taylor Ct	0	0	0
20	207	Meriwether Cir	2	0	0
21	387	Eastwood Glen Dr /	4	0	0
22	840	Chappelle Ln	0	0	0
23	758	Taylor Park Rd	0	0	0
24	790	Vaughn Rd	111	144	99
Totals	17178		169	181	153

Congestion Management Plan Update

Montgomery MPO

Study Name : **Taylor Rd PM SB Study**
 Study Date : **10/28/2013**
 Page No. : **9**

Detailed Statistics By Run

Time <= 45 MPH by Section

Taylor Rd PM-SB-001 t
 Taylor Rd PM-SB-002 t
 Taylor Rd PM-SB-003 t

Node #	Length	Node Name	Run #1	Run #2	Run #3
1	0	Atlanta Hwy			
2	904	Winton Blount Loop	26	22	24
3	757	Winton Blount Loop	32	15	15
4	1026	Copperfield Dr	21	19	20
5	783	Sydney Curve	13	15	14
6	1543	University Ct	26	28	27
7	541	East Dr / Halcyon	8	9	36
8	1096	Wadsworth Way /	2	10	19
9	762	I-85 WB Ramps	0	12	12
10	496	I-85	1	8	8
11	563	I-85 EB Ramps	9	29	11
12	1049	Eastchase Pkwy	5	20	17
13	531	Halcyon Forest Trl	0	9	2
14	496	Berryhill Rd	0	8	8
15	852	Barnett Rd / Halcyon Blvd	0	14	2
16	1901	Taylor Cir	0	9	0
17	303	Prairie Ln	0	5	0
18	75	Taylor Cir	0	1	0
19	518	Taylor Ct	2	7	1
20	207	Meriwether Cir	4	3	3
21	387	Eastwood Glen Dr /	9	6	7
22	840	Chappelle Ln	14	1	10
23	758	Taylor Park Rd	13	12	12
24	790	Vaughn Rd	112	154	104
Totals	17178		297	416	352

Congestion Management Plan Update

Montgomery MPO

Study Name : Taylor Rd PM SB Study
 Study Date : 10/28/2013
 Page No. : 10

Speed/Distance Profiles of All Runs

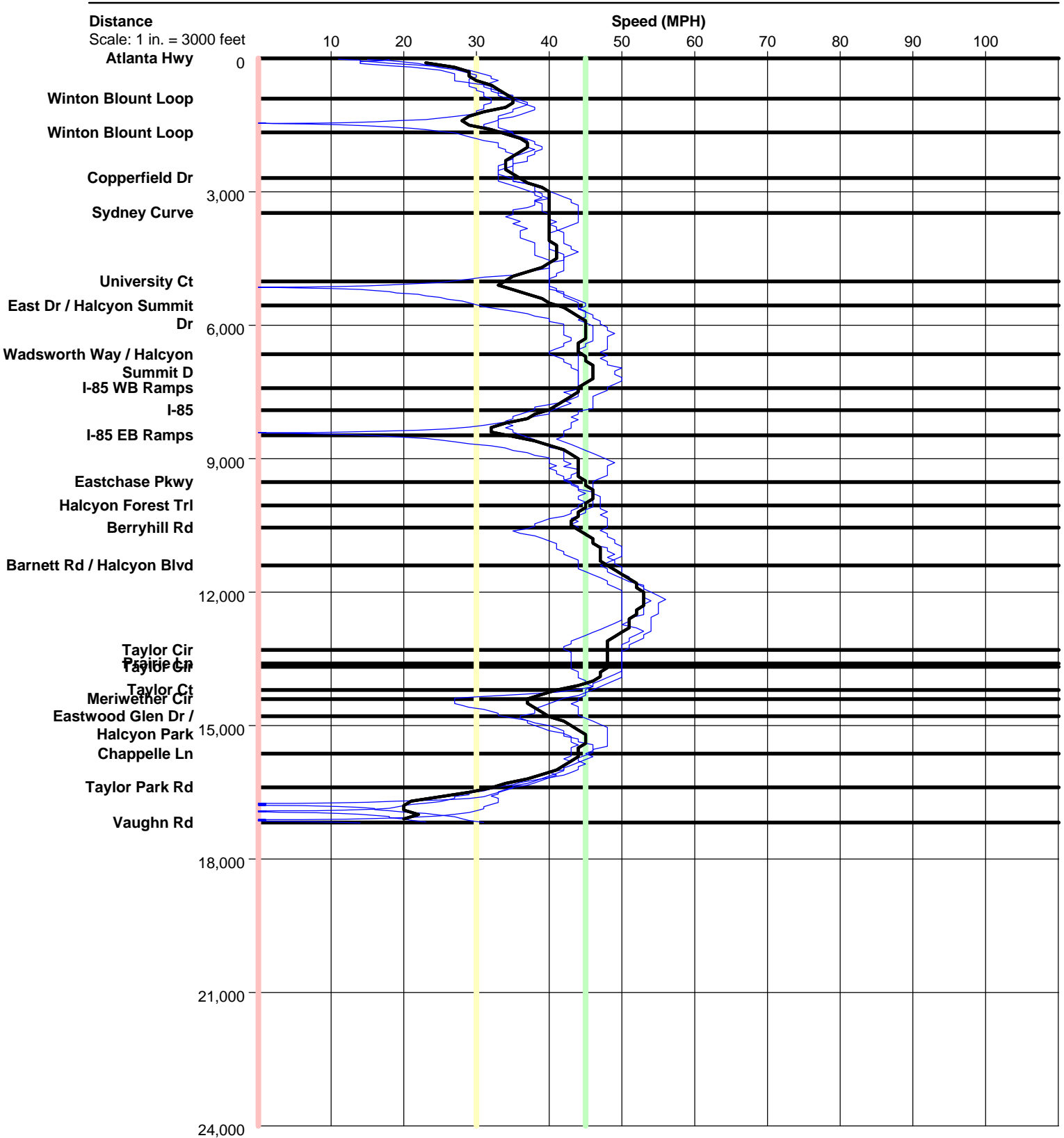

Taylor Rd PM SB

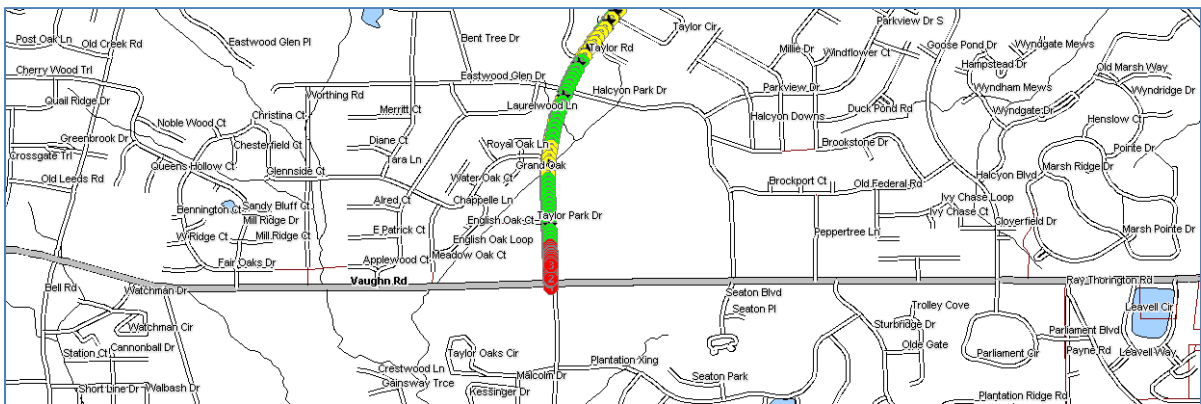
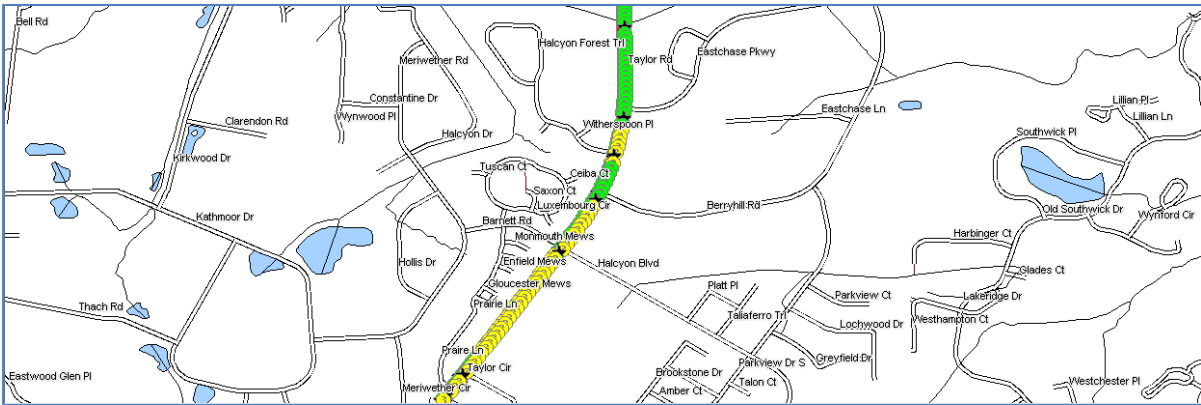
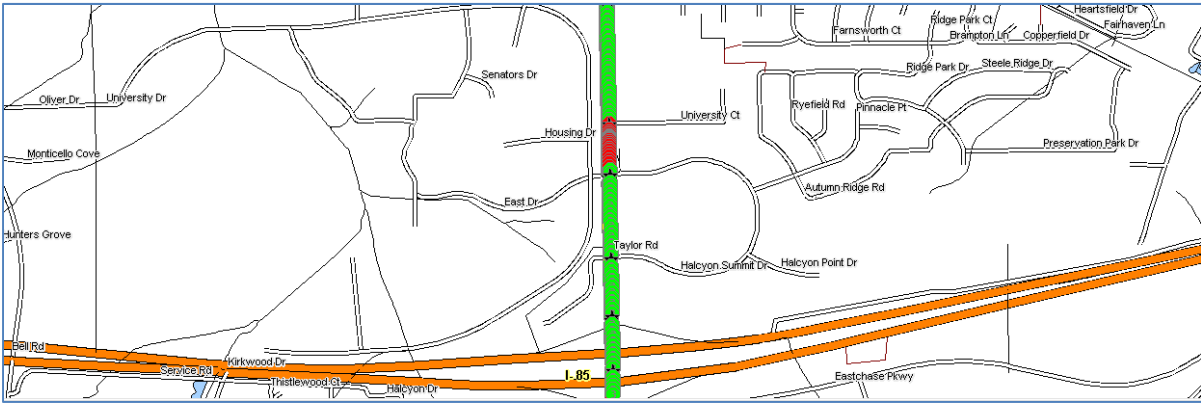
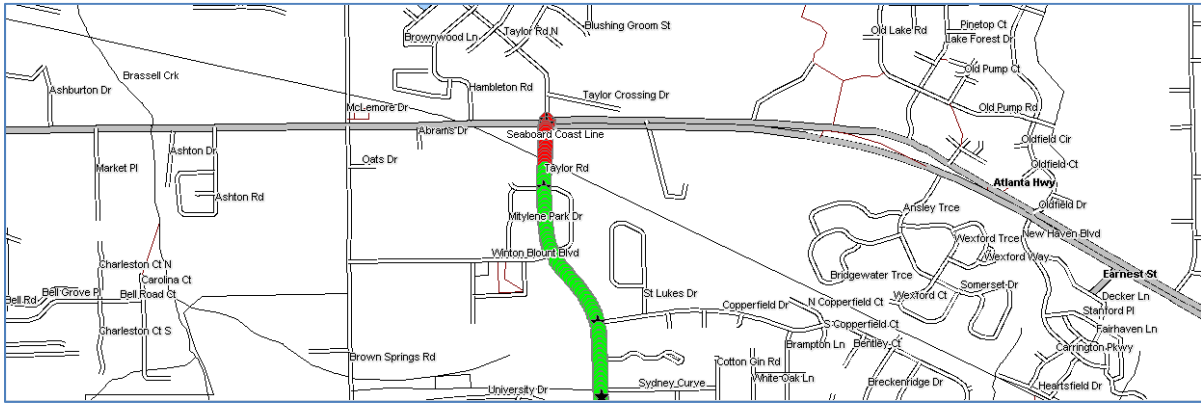

Color Code Speeds

■ Speed 1	0	To	30
■ Speed 2	30	To	45
■ Speed 3	45	To	99