

**Congestion Management Plan Update**  
Montgomery MPO

---

***PC-Travel Reports for study: Perry Hill Rd AM SB Study***

<u>Report Name</u>	<u>Page</u>
Study Summary .....	2
Overall Output Statistics .....	3
Detailed Statistics By Run - Travel Times .....	4
Detailed Statistics By Run - Average Speed .....	5
Detailed Statistics By Run - Total Delay .....	6
Detailed Statistics By Run - Time <= 0 MPH .....	7
Detailed Statistics By Run - Time <= 20 MPH .....	8
Detailed Statistics By Run - Time <= 35 MPH .....	9
Speed/Distance Profiles of All Runs .....	10

# Congestion Management Plan Update

Montgomery MPO

Study Name : **Perry Hill Rd AM SB Study**  
 Study Date : **1/21/2014**  
 Page No. : **2**

## Study Summary

### *Runs Used in This Study*

Run Title	Start Date	Start Time	Length	Before/ After	Run Type
Perry Hill Rd AM-SB-001 t	01/21/14	07:40	2936	Before	Secondary
Perry Hill Rd AM-SB-002 t	01/21/14	07:53	3081	Before	Secondary
Perry Hill Rd AM-SB-003 t	01/21/14	08:04	3084	Before	Secondary

### *Node Info*

#	Len	Name
1	0	Harrison Rd
2	141	Fain Ct
3	590	Beth Manor Dr
4	1041	Elmdale Rd / Interstate
5	334	Interstate Ct
6	451	I-85 WB Ramps
7	427	I-85

### **Notes:**

Length of Study Route = 2,984 feet

# Congestion Management Plan Update

## Montgomery MPO

Study Name : Perry Hill Rd AM SB Study  
 Study Date : 1/21/2014  
 Page No. : 3

### Overall Output Statistics

Node #	Length	Node	Travel Time	# of Stops	Avg Speed	Total Delay	Time <= 0 MPH	Time <= 20 MPH	Time <= 35 MPH
1	0	Harrison Rd							
2	141	Fain Ct	4.0	0.0	24.0	1.0	0.0	0.7	3.0
3	590	Beth Manor Dr	11.3	0.0	35.5	0.0	0.0	0.0	7.7
4	1041	Elmdale Rd / Interstate Park	56.7	1.0	12.5	36.7	7.7	39.7	47.7
5	334	Interstate Ct	27.0	0.7	8.4	20.0	8.0	20.7	27.0
6	451	I-85 WB Ramps	31.7	0.7	9.7	22.7	3.3	31.0	31.7
7	427	I-85	47.3	0.7	6.2	39.0	17.0	47.0	47.0
<b>Total</b>	<b>2,984</b>		<b>178.0</b>	<b>3.0</b>	<b>11.4</b>	<b>119.3</b>	<b>36.0</b>	<b>139.0</b>	<b>164.0</b>

Stats based on 3 BEFORE runs.  
 Stops based on a Stop Speed of 5 MPH.  
 Total Delay based on a Normal Speed of 35 MPH.

# Congestion Management Plan Update

## Montgomery MPO

Study Name : **Perry Hill Rd AM SB Study**  
 Study Date : **1/21/2014**  
 Page No. : **4**

### Detailed Statistics By Run

#### Travel Time (sec) by Section

Perry Hill Rd AM-SB-001 t  
 Perry Hill Rd AM-SB-002 t  
 Perry Hill Rd AM-SB-003 t

Node #	Length	Node Name	Run #1	Run #2	Run #3
1	0	Harrison Rd			
2	141	Fain Ct	4	5	3
3	590	Beth Manor Dr	12	12	10
4	1041	Elmdale Rd / Interstate	19	93	58
5	334	Interstate Ct	8	63	10
6	451	I-85 WB Ramps	27	22	46
7	427	I-85	45	75	22
<b>Totals</b>	<b>2984</b>		<b>115</b>	<b>270</b>	<b>149</b>

# Congestion Management Plan Update

## Montgomery MPO

Study Name : **Perry Hill Rd AM SB Study**  
 Study Date : **1/21/2014**  
 Page No. : **5**

### Detailed Statistics By Run

#### Average Speed (MPH) by Section

Perry Hill Rd AM-SB-001 t  
 Perry Hill Rd AM-SB-002 t  
 Perry Hill Rd AM-SB-003 t

Node #	Length	Node Name	Run #1	Run #2	Run #3
1	0	Harrison Rd			
2	141	Fain Ct	28.8	21.6	42.3
3	590	Beth Manor Dr	33.6	32.8	39.0
4	1041	Elmdale Rd / Interstate	38.0	7.8	12.1
5	334	Interstate Ct	26.6	3.8	23.7
6	451	I-85 WB Ramps	11.0	13.5	6.7
7	427	I-85	5.7	3.9	13.1
<b>Totals</b>	<b>2984</b>		<b>17.6</b>	<b>7.6</b>	<b>13.8</b>

# Congestion Management Plan Update

## Montgomery MPO

Study Name : **Perry Hill Rd AM SB Study**  
 Study Date : **1/21/2014**  
 Page No. : **6**

### Detailed Statistics By Run

#### Total Delay (sec) by Section

Perry Hill Rd AM-SB-001 t  
 Perry Hill Rd AM-SB-002 t  
 Perry Hill Rd AM-SB-003 t

Node #	Length	Node Name	Run #1	Run #2	Run #3
1	0	Harrison Rd			
2	141	Fain Ct	1	2	0
3	590	Beth Manor Dr	0	0	0
4	1041	Elmdale Rd / Interstate	0	72	38
5	334	Interstate Ct	1	56	3
6	451	I-85 WB Ramps	18	13	37
7	427	I-85	37	67	13
<b>Totals</b>	<b>2984</b>		<b>57</b>	<b>210</b>	<b>91</b>

Total Delay based on a Normal Speed of 35 MPH.

# Congestion Management Plan Update

## Montgomery MPO

Study Name : **Perry Hill Rd AM SB Study**  
 Study Date : **1/21/2014**  
 Page No. : **7**

### Detailed Statistics By Run

#### Time <= 0 MPH by Section

Perry Hill Rd AM-SB-001 t  
 Perry Hill Rd AM-SB-002 t  
 Perry Hill Rd AM-SB-003 t

Node #	Length	Node Name	Run #1	Run #2	Run #3
1	0	Harrison Rd			
2	141	Fain Ct	0	0	0
3	590	Beth Manor Dr	0	0	0
4	1041	Elmdale Rd / Interstate	0	14	9
5	334	Interstate Ct	0	24	0
6	451	I-85 WB Ramps	0	0	10
7	427	I-85	13	38	0
<b>Totals</b>	<b>2984</b>		<b>13</b>	<b>76</b>	<b>19</b>

# Congestion Management Plan Update

## Montgomery MPO

Study Name : **Perry Hill Rd AM SB Study**  
 Study Date : **1/21/2014**  
 Page No. : **8**

### Detailed Statistics By Run

#### Time <= 20 MPH by Section

Perry Hill Rd AM-SB-001 t  
 Perry Hill Rd AM-SB-002 t  
 Perry Hill Rd AM-SB-003 t

Node #	Length	Node Name	Run #1	Run #2	Run #3
1	0	Harrison Rd			
2	141	Fain Ct	0	2	0
3	590	Beth Manor Dr	0	0	0
4	1041	Elmdale Rd / Interstate	0	77	42
5	334	Interstate Ct	1	59	2
6	451	I-85 WB Ramps	27	20	46
7	427	I-85	44	75	22
<b>Totals</b>	<b>2984</b>		<b>72</b>	<b>233</b>	<b>112</b>



# Congestion Management Plan Update

## Montgomery MPO

Study Name : **Perry Hill Rd AM SB Study**  
 Study Date : **1/21/2014**  
 Page No. : **9**

### Detailed Statistics By Run

#### Time <= 35 MPH by Section

Perry Hill Rd AM-SB-001 t  
 Perry Hill Rd AM-SB-002 t  
 Perry Hill Rd AM-SB-003 t

Node #	Length	Node Name	Run #1	Run #2	Run #3
1	0	Harrison Rd			
2	141	Fain Ct	4	5	0
3	590	Beth Manor Dr	11	12	0
4	1041	Elmdale Rd / Interstate	2	93	48
5	334	Interstate Ct	8	63	10
6	451	I-85 WB Ramps	27	22	46
7	427	I-85	44	75	22
<b>Totals</b>	<b>2984</b>		<b>96</b>	<b>270</b>	<b>126</b>

# Congestion Management Plan Update

Montgomery MPO

Study Name : Perry Hill Rd AM SB Study  
Study Date : 1/21/2014  
Page No. : 10

## Speed/Distance Profiles of All Runs

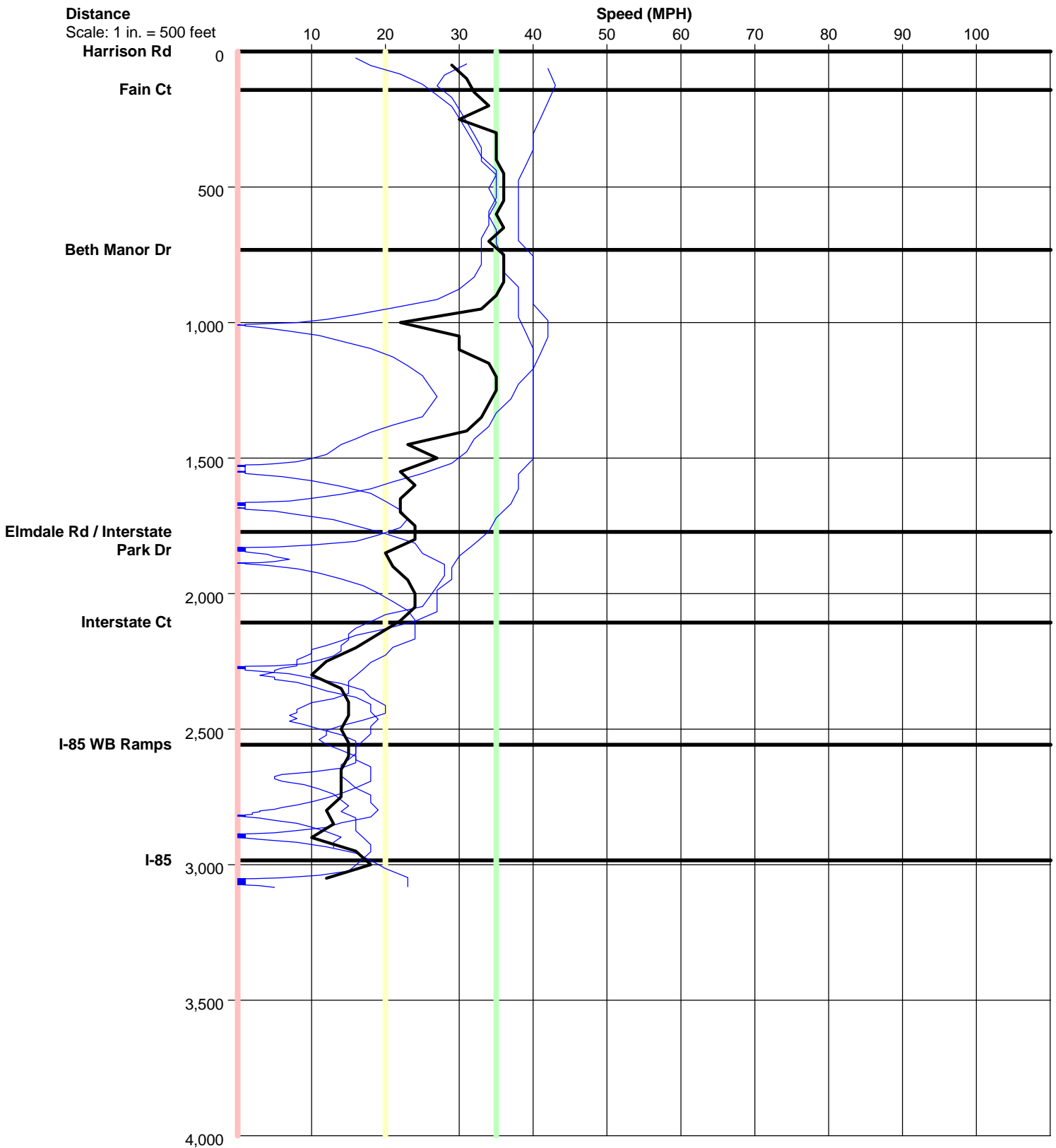

# Perry Hill Rd AM SB

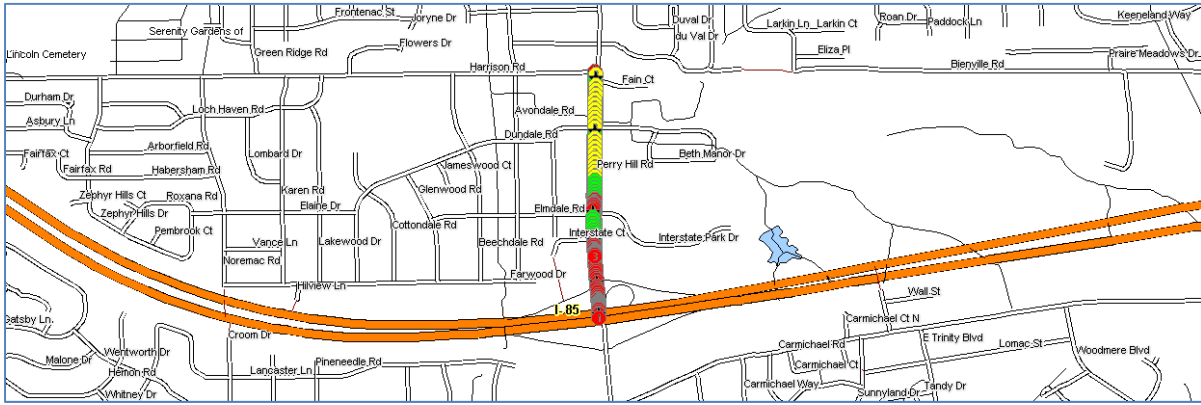

Color Code Speeds

Speed 1	0	To	20
Speed 2	20	To	35
Speed 3	35	To	99