

Congestion Management Plan Update
Montgomery MPO

PC-Travel Reports for study: Taylor Rd OP SB Study

<u>Report Name</u>	<u>Page</u>
Study Summary	2
Overall Output Statistics	3
Detailed Statistics By Run - Travel Times	4
Detailed Statistics By Run - Average Speed	5
Detailed Statistics By Run - Total Delay	6
Detailed Statistics By Run - Time <= 0 MPH	7
Detailed Statistics By Run - Time <= 30 MPH	8
Detailed Statistics By Run - Time <= 45 MPH	9
Speed/Distance Profiles of All Runs	10

Congestion Management Plan Update Montgomery MPO

Study Name : **Taylor Rd OP SB Study**
Study Date : **11/19/2013**
Page No. : **2**

Study Summary

Runs Used in This Study

Run Title	Start Date	Start Time	Length	Before/After	Run Type
Taylor Rd OP-SB-001 t	11/19/13	10:16	17212	Before	Secondary
Taylor Rd OP-SB-002 t	10/22/13	10:31	17178	Before	Secondary
Taylor Rd OP-SB-003 t	11/19/13	13:47	17169	Before	Secondary

Notes:

Node Info

#	Len	Name
1	0	Atlanta Hwy
2	904	Winton Blount Loop
3	757	Winton Blount Loop
4	1026	Copperfield Dr
5	783	Sydney Curve
6	1543	University Ct
7	541	East Dr / Halcyon
8	1096	Wadsworth Way /
9	762	I-85 WB Ramps
10	496	I-85
11	563	I-85 EB Ramps
12	1049	Eastchase Pkwy
13	531	Halcyon Forest Trl
14	496	Berryhill Rd
15	852	Barnett Rd / Halcyon
16	1901	Taylor Cir
17	303	Prairie Ln
18	75	Taylor Cir
19	518	Taylor Ct
20	207	Meriwether Cir
21	387	Eastwood Glen Dr /
22	840	Chappelle Ln
23	758	Taylor Park Rd
24	790	Vaughn Rd

Length of Study Route = 17,178 feet

Congestion Management Plan Update

Montgomery MPO

Study Name : **Taylor Rd OP SB Study**
 Study Date : **11/19/2013**
 Page No. : **3**

Overall Output Statistics

Node #	Length	Node	Travel Time	# of Stops	Avg Speed	Total Delay	Time <= 0 MPH	Time <= 30 MPH	Time <= 45 MPH
1	0	Atlanta Hwy							
2	904	Winton Blount Loop	20.3	0.0	30.3	4.7	0.0	9.0	20.3
3	757	Winton Blount Loop	29.0	0.7	17.8	16.3	8.3	19.0	29.0
4	1026	Copperfield Dr	29.3	0.3	23.8	12.3	5.3	15.3	27.3
5	783	Sydney Curve	14.3	0.0	37.2	2.0	0.0	4.0	8.7
6	1543	University Ct	23.7	0.0	44.5	0.3	0.0	0.0	14.7
7	541	East Dr / Halcyon Summit Dr	30.3	0.7	12.2	22.3	8.0	25.0	30.3
8	1096	Wadsworth Way / Halcyon	18.7	0.0	40.0	1.7	0.0	1.0	15.7
9	762	I-85 WB Ramps	11.7	0.0	44.5	0.0	0.0	0.0	8.0
10	496	I-85	7.7	0.0	44.1	0.3	0.0	0.0	5.7
11	563	I-85 EB Ramps	24.0	0.3	16.0	15.3	7.7	16.3	21.3
12	1049	Eastchase Pkwy	16.7	0.0	42.9	1.3	0.0	1.0	12.0
13	531	Halcyon Forest Trl	7.7	0.0	47.2	0.0	0.0	0.0	3.0
14	496	Berryhill Rd	7.3	0.0	46.1	0.3	0.0	0.0	3.3
15	852	Barnett Rd / Halcyon Blvd	24.3	0.7	23.9	11.3	4.3	14.0	20.0
16	1901	Taylor Cir	27.0	0.0	48.0	0.0	0.0	1.3	7.0
17	303	Prairie Ln	3.7	0.0	56.3	0.0	0.0	0.0	0.0
18	75	Taylor Cir	1.0	0.0	51.1	0.0	0.0	0.0	0.0
19	518	Taylor Ct	6.7	0.0	53.0	0.0	0.0	0.0	0.0
20	207	Meriwether Cir	3.0	0.0	47.0	0.0	0.0	0.0	0.0
21	387	Eastwood Glen Dr / Halcyon	8.3	0.3	31.7	3.7	0.0	4.3	5.3
22	840	Chappelle Ln	13.3	0.0	43.0	2.7	0.0	1.0	6.0
23	758	Taylor Park Rd	10.7	0.0	48.5	1.3	0.0	0.0	5.7
24	790	Vaughn Rd	26.3	0.3	20.5	16.3	5.3	14.0	25.3
Total	17,178		365.0	3.3	32.1	112.3	39.0	125.3	268.7

Stats based on 3 BEFORE runs.
 Stops based on a Stop Speed of 5 MPH.

Congestion Management Plan Update

Montgomery MPO

Study Name : **Taylor Rd OP SB Study**
 Study Date : **11/19/2013**
 Page No. : **4**

Detailed Statistics By Run

Travel Time (sec) by Section

Taylor Rd OP-SB-001 t
Taylor Rd OP-SB-002 t
Taylor Rd OP-SB-003 t

Node #	Length	Node Name	Run #1	Run #2	Run #3
1	0	Atlanta Hwy			
2	904	Winton Blount Loop	19	22	20
3	757	Winton Blount Loop	40	35	12
4	1026	Copperfield Dr	18	54	16
5	783	Sydney Curve	12	19	12
6	1543	University Ct	22	27	22
7	541	East Dr / Halcyon	40	9	42
8	1096	Wadsworth Way /	19	17	20
9	762	I-85 WB Ramps	11	12	12
10	496	I-85	6	9	8
11	563	I-85 EB Ramps	8	54	10
12	1049	Eastchase Pkwy	14	19	17
13	531	Halcyon Forest Trl	7	8	8
14	496	Berryhill Rd	6	9	7
15	852	Barnett Rd / Halcyon Blvd	33	14	26
16	1901	Taylor Cir	27	26	28
17	303	Prairie Ln	3	4	4
18	75	Taylor Cir	1	1	1
19	518	Taylor Ct	6	7	7
20	207	Meriwether Cir	3	3	3
21	387	Eastwood Glen Dr /	4	16	5
22	840	Chappelle Ln	11	16	13
23	758	Taylor Park Rd	9	12	11
24	790	Vaughn Rd	15	13	51
Totals	17178		334	406	355

Congestion Management Plan Update

Montgomery MPO

Study Name : Taylor Rd OP SB Study
 Study Date : 11/19/2013
 Page No. : 5

Detailed Statistics By Run

Average Speed (MPH) by Section

Taylor Rd OP-SB-001 t
 Taylor Rd OP-SB-002 t
 Taylor Rd OP-SB-003 t

Node #	Length	Node Name	Run #1	Run #2	Run #3
1	0	Atlanta Hwy			
2	904	Winton Blount Loop	33.8	28.0	32.3
3	757	Winton Blount Loop	12.6	14.7	41.9
4	1026	Copperfield Dr	38.6	12.9	44.2
5	783	Sydney Curve	47.7	28.2	46.4
6	1543	University Ct	46.3	39.0	46.2
7	541	East Dr / Halcyon	9.4	41.0	8.8
8	1096	Wadsworth Way /	39.4	44.0	38.5
9	762	I-85 WB Ramps	49.3	43.3	43.0
10	496	I-85	52.3	37.7	41.4
11	563	I-85 EB Ramps	50.3	7.2	38.0
12	1049	Eastchase Pkwy	49.4	37.7	42.9
13	531	Halcyon Forest Trl	54.1	45.4	44.5
14	496	Berryhill Rd	57.0	37.6	47.3
15	852	Barnett Rd / Halcyon Blvd	16.8	41.5	22.1
16	1901	Taylor Cir	49.9	49.8	47.2
17	303	Prairie Ln	56.7	51.5	51.5
18	75	Taylor Cir	57.0	51.0	52.0
19	518	Taylor Ct	58.5	50.3	50.9
20	207	Meriwether Cir	55.7	47.3	47.7
21	387	Eastwood Glen Dr /	55.0	16.5	47.4
22	840	Chappelle Ln	55.5	35.9	45.9
23	758	Taylor Park Rd	52.9	43.2	45.6
24	790	Vaughn Rd	37.1	41.6	10.3
Totals	17178		35.1	28.9	33.1

Congestion Management Plan Update

Montgomery MPO

Study Name : **Taylor Rd OP SB Study**
 Study Date : **11/19/2013**
 Page No. : **6**

Detailed Statistics By Run

Total Delay (sec) by Section

Taylor Rd OP-SB-001 t
 Taylor Rd OP-SB-002 t
 Taylor Rd OP-SB-003 t

Node #	Length	Node Name	Run #1	Run #2	Run #3
1	0	Atlanta Hwy			
2	904	Winton Blount Loop	3	7	4
3	757	Winton Blount Loop	27	22	0
4	1026	Copperfield Dr	0	37	0
5	783	Sydney Curve	0	6	0
6	1543	University Ct	0	1	0
7	541	East Dr / Halcyon	32	1	34
8	1096	Wadsworth Way /	2	0	3
9	762	I-85 WB Ramps	0	0	0
10	496	I-85	0	1	0
11	563	I-85 EB Ramps	0	45	1
12	1049	Eastchase Pkwy	0	3	1
13	531	Halcyon Forest Trl	0	0	0
14	496	Berryhill Rd	0	1	0
15	852	Barnett Rd / Halcyon Blvd	20	1	13
16	1901	Taylor Cir	0	0	0
17	303	Prairie Ln	0	0	0
18	75	Taylor Cir	0	0	0
19	518	Taylor Ct	0	0	0
20	207	Meriwether Cir	0	0	0
21	387	Eastwood Glen Dr /	0	11	0
22	840	Chappelle Ln	0	6	2
23	758	Taylor Park Rd	0	3	1
24	790	Vaughn Rd	5	3	41
Totals	17178		89	148	100

Congestion Management Plan Update

Montgomery MPO

Study Name : **Taylor Rd OP SB Study**
 Study Date : **11/19/2013**
 Page No. : **7**

Detailed Statistics By Run

Time <= 0 MPH by Section

Taylor Rd OP-SB-001 t
 Taylor Rd OP-SB-002 t
 Taylor Rd OP-SB-003 t

Node #	Length	Node Name	Run #1	Run #2	Run #3
1	0	Atlanta Hwy			
2	904	Winton Blount Loop	0	0	0
3	757	Winton Blount Loop	14	11	0
4	1026	Copperfield Dr	0	16	0
5	783	Sydney Curve	0	0	0
6	1543	University Ct	0	0	0
7	541	East Dr / Halcyon	13	0	11
8	1096	Wadsworth Way /	0	0	0
9	762	I-85 WB Ramps	0	0	0
10	496	I-85	0	0	0
11	563	I-85 EB Ramps	0	23	0
12	1049	Eastchase Pkwy	0	0	0
13	531	Halcyon Forest Trl	0	0	0
14	496	Berryhill Rd	0	0	0
15	852	Barnett Rd / Halcyon Blvd	10	0	3
16	1901	Taylor Cir	0	0	0
17	303	Prairie Ln	0	0	0
18	75	Taylor Cir	0	0	0
19	518	Taylor Ct	0	0	0
20	207	Meriwether Cir	0	0	0
21	387	Eastwood Glen Dr /	0	0	0
22	840	Chappelle Ln	0	0	0
23	758	Taylor Park Rd	0	0	0
24	790	Vaughn Rd	0	0	16
Totals	17178		37	50	30

Congestion Management Plan Update

Montgomery MPO

Study Name : **Taylor Rd OP SB Study**
 Study Date : **11/19/2013**
 Page No. : **8**

Detailed Statistics By Run

Time <= 30 MPH by Section

Taylor Rd OP-SB-001 t
 Taylor Rd OP-SB-002 t
 Taylor Rd OP-SB-003 t

Node #	Length	Node Name	Run #1	Run #2	Run #3
1	0	Atlanta Hwy			
2	904	Winton Blount Loop	4	16	7
3	757	Winton Blount Loop	32	25	0
4	1026	Copperfield Dr	1	45	0
5	783	Sydney Curve	0	12	0
6	1543	University Ct	0	0	0
7	541	East Dr / Halcyon	35	0	40
8	1096	Wadsworth Way /	3	0	0
9	762	I-85 WB Ramps	0	0	0
10	496	I-85	0	0	0
11	563	I-85 EB Ramps	0	49	0
12	1049	Eastchase Pkwy	0	3	0
13	531	Halcyon Forest Trl	0	0	0
14	496	Berryhill Rd	0	0	0
15	852	Barnett Rd / Halcyon Blvd	24	0	18
16	1901	Taylor Cir	3	0	1
17	303	Prairie Ln	0	0	0
18	75	Taylor Cir	0	0	0
19	518	Taylor Ct	0	0	0
20	207	Meriwether Cir	0	0	0
21	387	Eastwood Glen Dr /	0	13	0
22	840	Chappelle Ln	0	3	0
23	758	Taylor Park Rd	0	0	0
24	790	Vaughn Rd	0	0	42
Totals	17178		102	166	108

Congestion Management Plan Update

Montgomery MPO

Study Name : **Taylor Rd OP SB Study**
 Study Date : **11/19/2013**
 Page No. : **9**

Detailed Statistics By Run

Time <= 45 MPH by Section

Taylor Rd OP-SB-001 t
 Taylor Rd OP-SB-002 t
 Taylor Rd OP-SB-003 t

Node #	Length	Node Name	Run #1	Run #2	Run #3
1	0	Atlanta Hwy			
2	904	Winton Blount Loop	19	22	20
3	757	Winton Blount Loop	40	35	12
4	1026	Copperfield Dr	18	54	10
5	783	Sydney Curve	3	19	4
6	1543	University Ct	9	27	8
7	541	East Dr / Halcyon	40	9	42
8	1096	Wadsworth Way /	13	14	20
9	762	I-85 WB Ramps	0	12	12
10	496	I-85	0	9	8
11	563	I-85 EB Ramps	0	54	10
12	1049	Eastchase Pkwy	0	19	17
13	531	Halcyon Forest Trl	0	4	5
14	496	Berryhill Rd	0	9	1
15	852	Barnett Rd / Halcyon Blvd	25	14	21
16	1901	Taylor Cir	8	5	8
17	303	Prairie Ln	0	0	0
18	75	Taylor Cir	0	0	0
19	518	Taylor Ct	0	0	0
20	207	Meriwether Cir	0	0	0
21	387	Eastwood Glen Dr /	0	16	0
22	840	Chappelle Ln	0	16	2
23	758	Taylor Park Rd	0	12	5
24	790	Vaughn Rd	13	13	50
Totals	17178		188	363	255

Congestion Management Plan Update

Montgomery MPO

Study Name : **Taylor Rd OP SB Study**
 Study Date : **11/19/2013**
 Page No. : **10**

Speed/Distance Profiles of All Runs

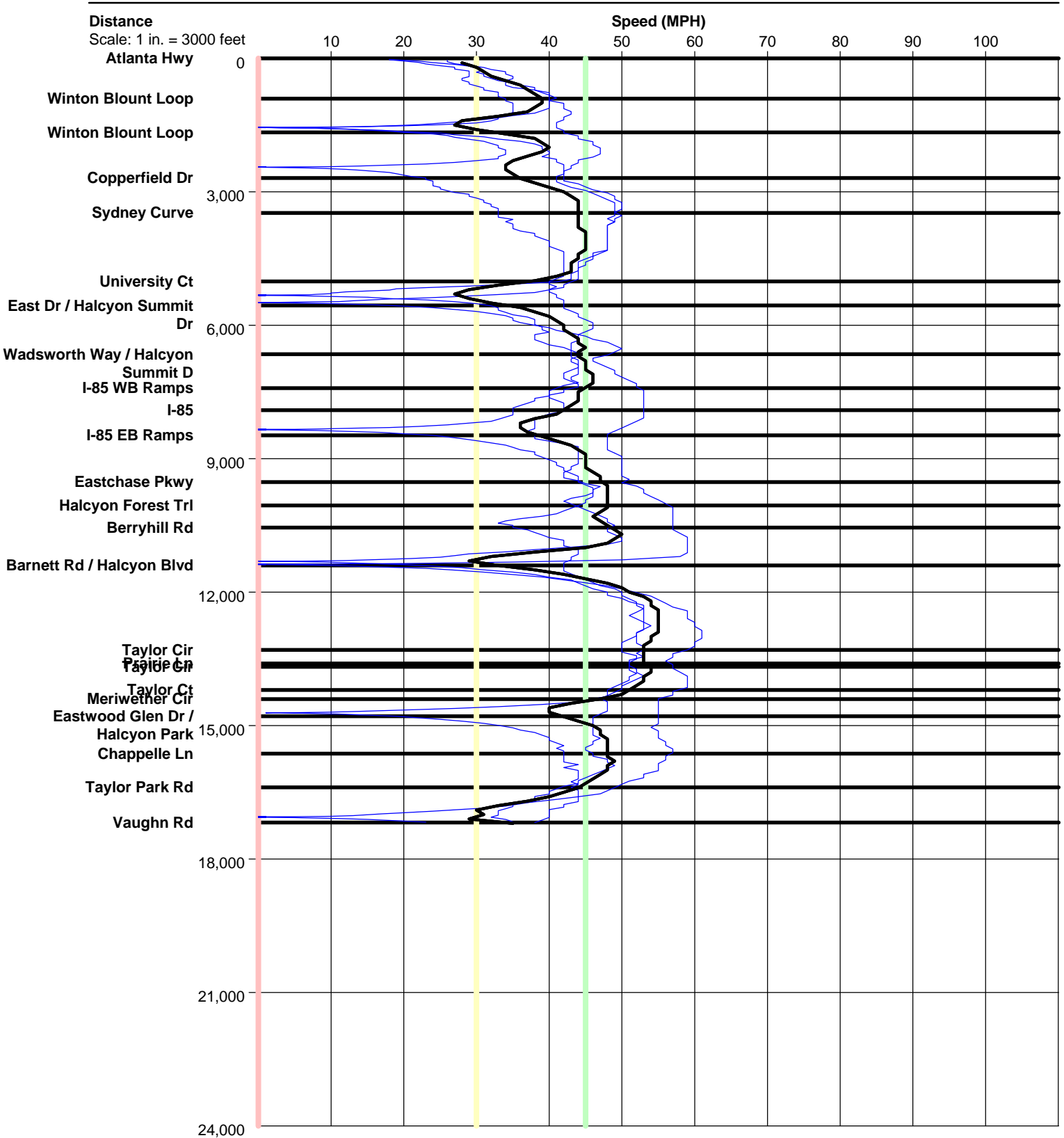

Taylor Rd OP SB

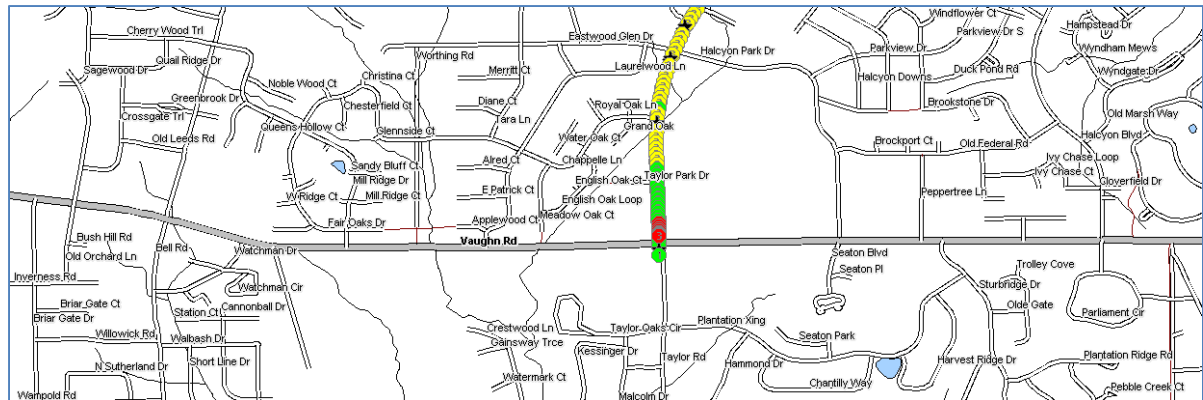
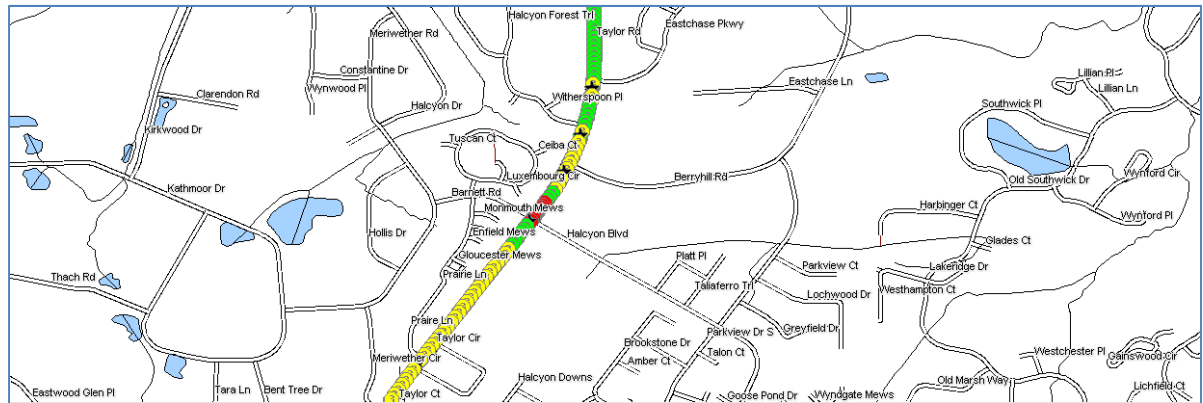
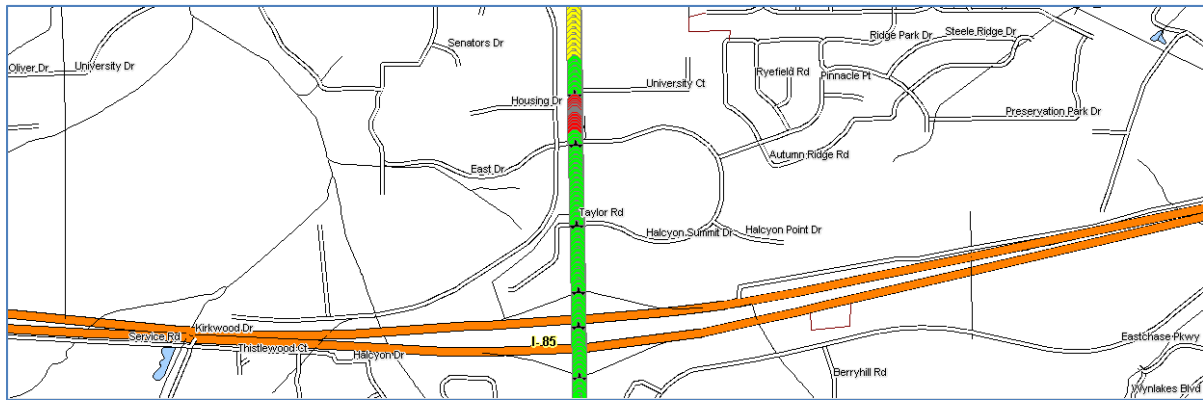
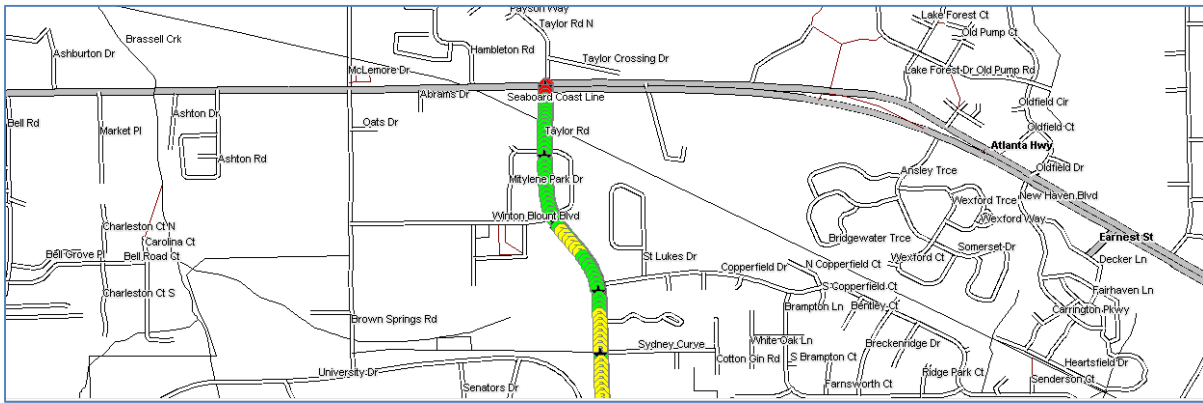

Color Code Speeds

Speed 1	0	To	30
Speed 2	30	To	45
Speed 3	45	To	99