

**Congestion Management Plan Update**  
Montgomery MPO

---

***PC-Travel Reports for study: S Perry Hill Rd PM SB Study***

| <u>Report Name</u>                                | <u>Page</u> |
|---|-------------|
| Study Summary .....                               | 2           |
| Overall Output Statistics .....                   | 3           |
| Detailed Statistics By Run - Travel Times .....   | 4           |
| Detailed Statistics By Run - Average Speed .....  | 5           |
| Detailed Statistics By Run - Total Delay .....    | 6           |
| Detailed Statistics By Run - Time <= 0 MPH .....  | 7           |
| Detailed Statistics By Run - Time <= 20 MPH ..... | 8           |
| Detailed Statistics By Run - Time <= 35 MPH ..... | 9           |
| Speed/Distance Profiles of All Runs .....         | 10          |

# Congestion Management Plan Update

Montgomery MPO

Study Name : **S Perry Hill Rd PM SB Study**  
 Study Date : **1/21/2014**  
 Page No. : **2**

## Study Summary

### *Runs Used in This Study*

| Run Title                   | Start Date | Start Time | Length | Before/ After | Run Type  |
|-----------------------------|------------|------------|--------|---------------|-----------|
| S Perry Hill Rd PM-SB-001 t | 01/21/14   | 16:06      | 3158   | Before        | Secondary |
| S Perry Hill Rd PM-SB-002 t | 01/21/14   | 16:15      | 3182   | Before        | Secondary |
| S Perry Hill Rd PM-SB-003 t | 01/21/14   | 16:28      | 3069   | Before        | Secondary |

### *Node Info*

| # | Len  | Name          |
|---|------|---------------|
| 1 | 0    | I-85          |
| 2 | 345  | I-85 EB Ramps |
| 3 | 761  | Carmichael Rd |
| 4 | 705  | Cairnbrook Dr |
| 5 | 1148 | Vaughn Rd     |

Length of Study Route = 2,959 feet

### **Notes:**

# Congestion Management Plan Update

## Montgomery MPO

Study Name : **S Perry Hill Rd PM SB Study**  
 Study Date : **1/21/2014**  
 Page No. : **3**

### Overall Output Statistics

| Node #       | Length       | Node          | Travel Time  | # of Stops | Avg Speed   | Total Delay | Time <= 0 MPH | Time <= 20 MPH | Time <= 35 MPH |
|--------------|--------------|---------------|--------------|------------|-------------|-------------|---------------|----------------|----------------|
| 1            | 0            | I-85          |              |            |             |             |               |                |                |
| 2            | 345          | I-85 EB Ramps | 7.7          | 0.0        | 30.7        | 0.7         | 0.0           | 0.0            | 5.7            |
| 3            | 761          | Carmichael Rd | 89.3         | 1.7        | 5.8         | 74.3        | 39.0          | 77.7           | 88.0           |
| 4            | 705          | Cairnbrook Dr | 11.7         | 0.0        | 41.2        | 0.0         | 0.0           | 0.3            | 3.0            |
| 5            | 1148         | Vaughn Rd     | 28.3         | 0.3        | 27.6        | 9.0         | 1.3           | 12.7           | 14.3           |
| <b>Total</b> | <b>2,959</b> |               | <b>137.0</b> | <b>2.0</b> | <b>14.7</b> | <b>84.0</b> | <b>40.3</b>   | <b>90.7</b>    | <b>111.0</b>   |

Stats based on 3 BEFORE runs.  
 Stops based on a Stop Speed of 5 MPH.  
 Total Delay based on a Normal Speed of 35 MPH.

# Congestion Management Plan Update

## Montgomery MPO

Study Name : **S Perry Hill Rd PM SB Study**  
 Study Date : **1/21/2014**  
 Page No. : **4**

### Detailed Statistics By Run

#### Travel Time (sec) by Section

S Perry Hill Rd PM-SB-001 t  
 S Perry Hill Rd PM-SB-002 t  
 S Perry Hill Rd PM-SB-003 t

| Node #        | Length      | Node Name     | Run #1     | Run #2     | Run #3    |
|---------------|-------------|---------------|------------|------------|-----------|
| 1             | 0           | I-85          |            |            |           |
| 2             | 345         | I-85 EB Ramps | 7          | 7          | 9         |
| 3             | 761         | Carmichael Rd | 118        | 123        | 27        |
| 4             | 705         | Cairnbrook Dr | 14         | 12         | 9         |
| 5             | 1148        | Vaughn Rd     | 16         | 50         | 19        |
| <b>Totals</b> | <b>2959</b> |               | <b>155</b> | <b>192</b> | <b>64</b> |

# Congestion Management Plan Update

## Montgomery MPO

Study Name : **S Perry Hill Rd PM SB Study**  
 Study Date : **1/21/2014**  
 Page No. : **5**

### Detailed Statistics By Run

#### Average Speed (MPH) by Section

*S Perry Hill Rd PM-SB-001 t*  
*S Perry Hill Rd PM-SB-002 t*  
*S Perry Hill Rd PM-SB-003 t*

| Node #        | Length      | Node Name     | Run #1      | Run #2      | Run #3      |
|---------------|-------------|---------------|-------------|-------------|-------------|
| 1             | 0           | I-85          |             |             |             |
| 2             | 345         | I-85 EB Ramps | 34.0        | 35.0        | 27.7        |
| 3             | 761         | Carmichael Rd | 4.5         | 4.4         | 18.8        |
| 4             | 705         | Cairnbrook Dr | 36.6        | 41.4        | 53.0        |
| 5             | 1148        | Vaughn Rd     | 48.8        | 15.3        | 41.3        |
| <b>Totals</b> | <b>2959</b> |               | <b>13.3</b> | <b>10.6</b> | <b>31.5</b> |

# Congestion Management Plan Update

## Montgomery MPO

Study Name : **S Perry Hill Rd PM SB Study**  
 Study Date : **1/21/2014**  
 Page No. : **6**

### Detailed Statistics By Run

#### Total Delay (sec) by Section

S Perry Hill Rd PM-SB-001 t  
 S Perry Hill Rd PM-SB-002 t  
 S Perry Hill Rd PM-SB-003 t

| Node # | Length | Node Name     | Run #1 | Run #2 | Run #3 |
|--------|--------|---------------|--------|--------|--------|
| 1      | 0      | I-85          |        |        |        |
| 2      | 345    | I-85 EB Ramps | 0      | 0      | 2      |
| 3      | 761    | Carmichael Rd | 103    | 108    | 12     |
| 4      | 705    | Cairnbrook Dr | 0      | 0      | 0      |
| 5      | 1148   | Vaughn Rd     | 0      | 27     | 0      |
| Totals | 2959   |               | 103    | 135    | 14     |

Total Delay based on a Normal Speed of 35 MPH.

# Congestion Management Plan Update

## Montgomery MPO

Study Name : **S Perry Hill Rd PM SB Study**  
 Study Date : **1/21/2014**  
 Page No. : **7**

### Detailed Statistics By Run

#### Time <= 0 MPH by Section

S Perry Hill Rd PM-SB-001 t  
 S Perry Hill Rd PM-SB-002 t  
 S Perry Hill Rd PM-SB-003 t

| Node #        | Length      | Node Name     | Run #1    | Run #2    | Run #3   |
|---------------|-------------|---------------|-----------|-----------|----------|
| 1             | 0           | I-85          |           |           |          |
| 2             | 345         | I-85 EB Ramps | 0         | 0         | 0        |
| 3             | 761         | Carmichael Rd | 66        | 51        | 0        |
| 4             | 705         | Cairnbrook Dr | 0         | 0         | 0        |
| 5             | 1148        | Vaughn Rd     | 0         | 4         | 0        |
| <b>Totals</b> | <b>2959</b> |               | <b>66</b> | <b>55</b> | <b>0</b> |

# Congestion Management Plan Update

## Montgomery MPO

Study Name : **S Perry Hill Rd PM SB Study**  
 Study Date : **1/21/2014**  
 Page No. : **8**

### Detailed Statistics By Run

#### Time <= 20 MPH by Section

*S Perry Hill Rd PM-SB-001 t*  
*S Perry Hill Rd PM-SB-002 t*  
*S Perry Hill Rd PM-SB-003 t*

| Node #        | Length      | Node Name     | Run #1     | Run #2     | Run #3    |
|---------------|-------------|---------------|------------|------------|-----------|
| 1             | 0           | I-85          |            |            |           |
| 2             | 345         | I-85 EB Ramps | 0          | 0          | 0         |
| 3             | 761         | Carmichael Rd | 106        | 111        | 16        |
| 4             | 705         | Cairnbrook Dr | 1          | 0          | 0         |
| 5             | 1148        | Vaughn Rd     | 0          | 35         | 3         |
| <b>Totals</b> | <b>2959</b> |               | <b>107</b> | <b>146</b> | <b>19</b> |



# Congestion Management Plan Update

## Montgomery MPO

Study Name : **S Perry Hill Rd PM SB Study**  
 Study Date : **1/21/2014**  
 Page No. : **9**

### Detailed Statistics By Run

#### Time <= 35 MPH by Section

S Perry Hill Rd PM-SB-001 t  
 S Perry Hill Rd PM-SB-002 t  
 S Perry Hill Rd PM-SB-003 t

| Node #        | Length      | Node Name     | Run #1     | Run #2     | Run #3    |
|---------------|-------------|---------------|------------|------------|-----------|
| 1             | 0           | I-85          |            |            |           |
| 2             | 345         | I-85 EB Ramps | 5          | 3          | 9         |
| 3             | 761         | Carmichael Rd | 118        | 123        | 23        |
| 4             | 705         | Cairnbrook Dr | 6          | 3          | 0         |
| 5             | 1148        | Vaughn Rd     | 0          | 38         | 5         |
| <b>Totals</b> | <b>2959</b> |               | <b>129</b> | <b>167</b> | <b>37</b> |

# Congestion Management Plan Update

Montgomery MPO

Study Name : S Perry Hill Rd PM SB Study  
Study Date : 1/21/2014  
Page No. : 10

## Speed/Distance Profiles of All Runs

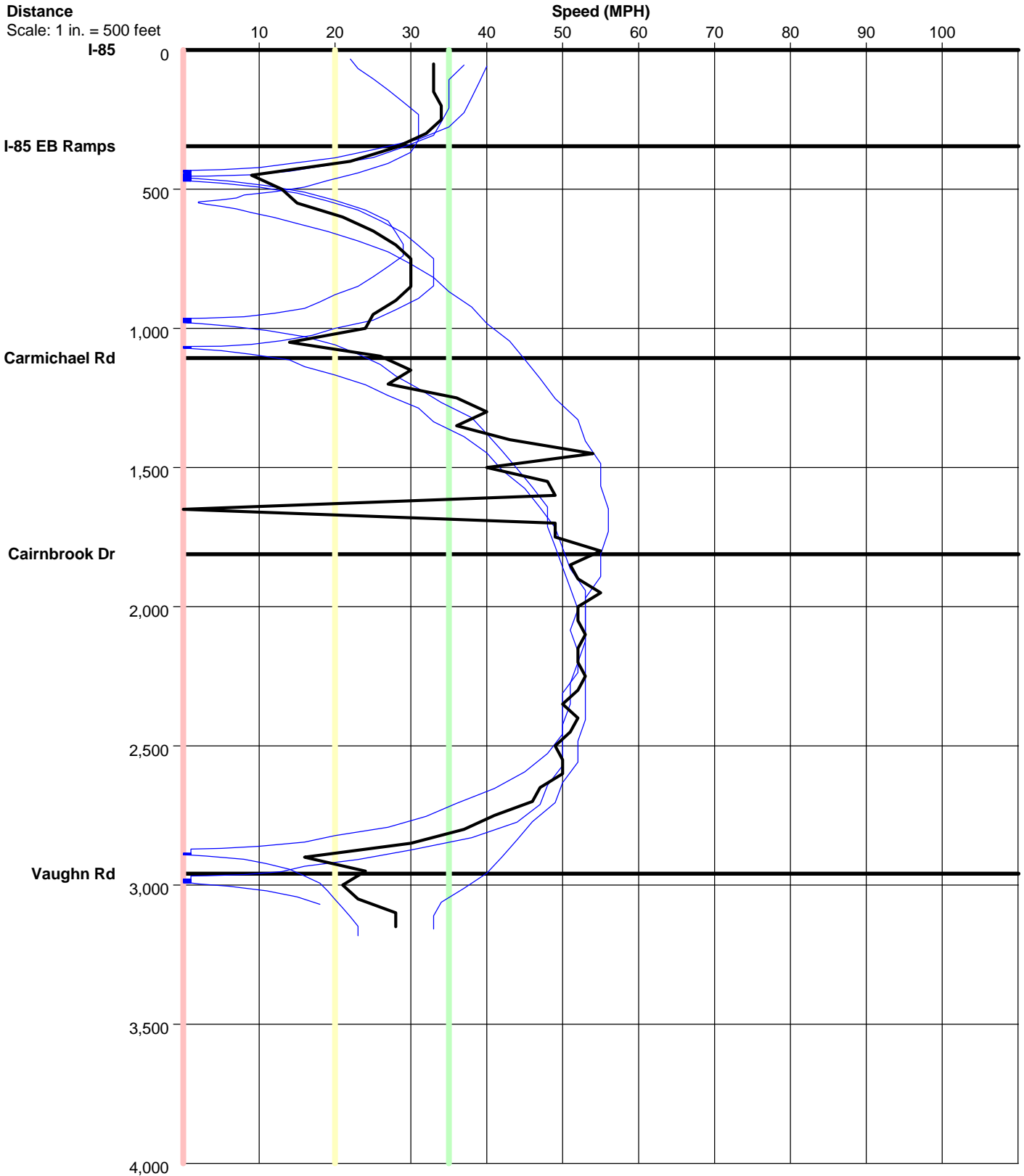

# S Perry Hill Rd PM SB

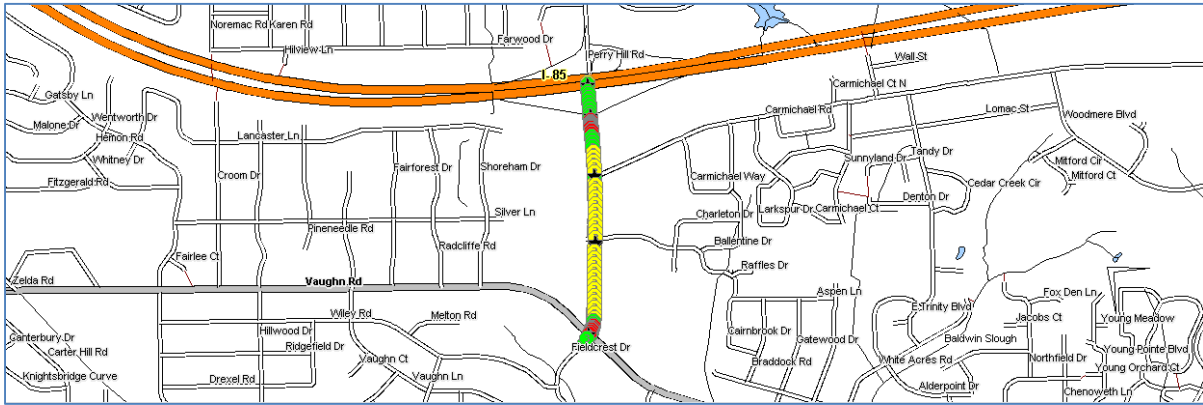

| <input checked="" type="checkbox"/> Color Code Speeds |         |    |       |
|---|---------|----|-------|
|   | Speed 1 | 0  | To 20 |
|   | Speed 2 | 20 | To 35 |
|   | Speed 3 | 35 | To 99 |