

Congestion Management Plan Update
Montgomery MPO

PC-Travel Reports for study: East Blvd AM NB Study

<u>Report Name</u>	<u>Page</u>
Study Summary	2
Overall Output Statistics	3
Detailed Statistics By Run - Travel Times	4
Detailed Statistics By Run - Average Speed	5
Detailed Statistics By Run - Total Delay	6
Detailed Statistics By Run - Time <= 0 MPH	7
Detailed Statistics By Run - Time <= 40 MPH	8
Detailed Statistics By Run - Time <= 55 MPH	9
Speed/Distance Profiles of All Runs	10

Congestion Management Plan Update Montgomery MPO

Study Name : **East Blvd AM NB Study**
Study Date : **12/16/2013**
Page No. : **2**

Study Summary

Runs Used in This Study

Run Title	Start Date	Start Time	Length	Before/After	Run Type
East Blvd AM-NB-001 t	12/16/13	08:43	41983	Before	Secondary
East Blvd AM-NB-002 t	12/17/13	07:18	42023	Before	Secondary
East Blvd AM-NB-003 t	12/17/13	07:54	42048	Before	Secondary

Notes:

Node Info

#	Len	Name
1	0	Troy Hwy
2	1480	Richard Rd
3	942	Christine Elizabeth
4	628	Unnamed Rd
5	522	Calmar Dr
6	541	Executive Park Dr
7	729	Park Blvd
8	1052	Buckboard Rd
9	1417	Carriage Hills Dr
10	998	Hitching Post Ln
11	1246	Vaughn Rd
12	1639	Young Barn Rd
13	1181	Arbor Station Rd
14	1647	Haskell Dr
15	968	Woodmere Blvd
16	1094	Carmichael Rd
17	598	I-85 EB Ramps
18	619	I-85
19	593	I-85 WB Ramps
20	646	Monticello Dr
21	2157	Shirley Ln
22	3991	Atlanta Hwy
23	3070	Unnamed Rd
24	470	Wares Ferry Rd
25	998	Aster Dr / Twain Curve
26	917	Hackel Dr
27	1183	Lagoon Park Dr /
28	2006	Todd Rd
29	1105	Robinson Cir
30	1059	Lagoon Business
31	6293	Wetumpka Hwy

Length of Study Route = 41,789 feet

Congestion Management Plan Update

Montgomery MPO

Study Name : East Blvd AM NB Study
 Study Date : 12/16/2013
 Page No. : 3

Overall Output Statistics

Node #	Length	Node	Travel Time	# of Stops	Avg Speed	Total Delay	Time <= 0 MPH	Time <= 40 MPH	Time <= 55 MPH
1	0	Troy Hwy							
2	1480	Richard Rd	28.0	0.0	36.0	9.0	0.0	19.3	28.0
3	942	Christine Elizabeth Curve	13.0	0.0	49.4	1.3	0.0	1.7	9.7
4	628	Unnamed Rd	9.7	0.0	44.3	1.7	0.0	1.3	9.7
5	522	Calmar Dr	8.0	0.0	44.5	1.0	0.0	0.0	8.0
6	541	Executive Park Dr	7.0	0.0	52.7	0.0	0.0	0.0	7.0
7	729	Park Blvd	9.3	0.0	53.3	0.0	0.0	0.0	5.7
8	1052	Buckboard Rd	13.3	0.0	53.8	0.3	0.0	1.0	6.3
9	1417	Carriage Hills Dr	18.3	0.0	52.7	0.7	0.0	1.7	11.3
10	998	Hitching Post Ln	21.7	0.3	31.4	9.0	0.0	11.3	21.3
11	1246	Vaughn Rd	48.3	0.7	17.6	33.0	9.7	37.7	48.3
12	1639	Young Barn Rd	46.7	0.0	23.9	26.0	9.0	26.7	46.7
13	1181	Arbor Station Rd	15.7	0.0	51.4	0.7	0.0	0.0	15.3
14	1647	Haskell Dr	22.0	0.0	51.0	1.0	0.0	1.7	19.0
15	968	Woodmere Blvd	27.7	0.7	23.9	15.7	2.7	18.3	27.7
16	1094	Carmichael Rd	20.3	0.0	36.7	6.3	0.0	13.3	20.3
17	598	I-85 EB Ramps	8.7	0.0	47.0	1.0	0.0	0.0	8.7
18	619	I-85	8.7	0.0	48.7	0.7	0.0	0.0	8.7
19	593	I-85 WB Ramps	9.0	0.0	44.9	1.0	0.0	3.3	9.0
20	646	Monticello Dr	10.0	0.0	44.0	1.3	0.0	4.3	10.0
21	2157	Shirley Ln	30.7	0.0	48.0	3.7	0.0	5.3	28.0
22	3991	Atlanta Hwy	73.3	0.3	37.1	24.7	13.0	27.3	40.7
23	3070	Unnamed Rd	34.7	0.0	60.4	0.0	0.0	0.0	3.3
24	470	Wares Ferry Rd	6.3	0.0	50.6	0.7	0.0	0.0	4.7
25	998	Aster Dr / Twain Curve	26.7	0.3	25.5	14.3	3.3	19.0	23.0
26	917	Hackel Dr	13.3	0.0	46.9	1.7	0.0	2.3	9.7
27	1183	Lagoon Park Dr / Plantation	27.0	0.3	29.9	12.0	0.3	16.7	25.0
28	2006	Todd Rd	38.3	0.3	35.7	13.0	2.3	14.3	38.3
29	1105	Robinson Cir	13.0	0.0	58.0	0.0	0.0	0.0	3.0
30	1059	Lagoon Business	11.7	0.0	61.9	0.0	0.0	0.0	0.0
31	6293	Wetumpka Hwy	66.0	0.0	65.0	0.0	0.0	0.0	0.0
Total	41,789		686.3	3.0	41.5	179.7	40.3	226.7	496.3

Stats based on 3 BEFORE runs.
 Stops based on a Stop Speed of 5 MPH.
 Total Delay based on a Normal Speed of 55 MPH.

Congestion Management Plan Update

Montgomery MPO

Study Name : East Blvd AM NB Study
 Study Date : 12/16/2013
 Page No. : 4

Detailed Statistics By Run

Travel Time (sec) by Section

East Blvd AM-NB-001 t
East Blvd AM-NB-002 t
East Blvd AM-NB-003 t

Node #	Length	Node Name	Run #1	Run #2	Run #3
1	0	Troy Hwy			
2	1480	Richard Rd	27	25	32
3	942	Christine Elizabeth Curve	13	11	15
4	628	Unnamed Rd	9	9	11
5	522	Calmar Dr	8	8	8
6	541	Executive Park Dr	7	7	7
7	729	Park Blvd	9	9	10
8	1052	Buckboard Rd	14	13	13
9	1417	Carriage Hills Dr	20	17	18
10	998	Hitching Post Ln	30	22	13
11	1246	Vaughn Rd	24	92	29
12	1639	Young Barn Rd	22	27	91
13	1181	Arbor Station Rd	16	15	16
14	1647	Haskell Dr	24	21	21
15	968	Woodmere Blvd	43	27	13
16	1094	Carmichael Rd	21	25	15
17	598	I-85 EB Ramps	9	8	9
18	619	I-85	9	9	8
19	593	I-85 WB Ramps	11	8	8
20	646	Monticello Dr	13	9	8
21	2157	Shirley Ln	33	29	30
22	3991	Atlanta Hwy	48	48	124
23	3070	Unnamed Rd	36	35	33
24	470	Wares Ferry Rd	6	8	5
25	998	Aster Dr / Twain Curve	49	20	11
26	917	Hackel Dr	14	15	11
27	1183	Lagoon Park Dr /	20	43	18
28	2006	Todd Rd	27	31	57
29	1105	Robinson Cir	13	14	12
30	1059	Lagoon Business	12	12	11
31	6293	Wetumpka Hwy	70	70	58
Totals	41789		657	687	715

Congestion Management Plan Update

Montgomery MPO

Study Name : East Blvd AM NB Study
 Study Date : 12/16/2013
 Page No. : 5

Detailed Statistics By Run

Average Speed (MPH) by Section

East Blvd AM-NB-001 t
East Blvd AM-NB-002 t
East Blvd AM-NB-003 t

Node #	Length	Node Name	Run #1	Run #2	Run #3
1	0	Troy Hwy			
2	1480	Richard Rd	38.5	41.6	31.9
3	942	Christine Elizabeth Curve	47.8	56.5	42.5
4	628	Unnamed Rd	47.8	49.7	40.5
5	522	Calmar Dr	48.6	45.6	45.9
6	541	Executive Park Dr	50.6	49.1	50.0
7	729	Park Blvd	54.8	55.2	53.0
8	1052	Buckboard Rd	49.6	58.6	53.1
9	1417	Carriage Hills Dr	48.2	56.5	52.9
10	998	Hitching Post Ln	22.8	29.1	54.5
11	1246	Vaughn Rd	37.3	9.2	28.1
12	1639	Young Barn Rd	49.7	43.1	12.4
13	1181	Arbor Station Rd	50.9	53.4	51.4
14	1647	Haskell Dr	46.9	53.9	54.0
15	968	Woodmere Blvd	15.1	22.8	49.8
16	1094	Carmichael Rd	34.6	30.9	48.2
17	598	I-85 EB Ramps	46.8	47.3	49.7
18	619	I-85	45.9	51.3	52.6
19	593	I-85 WB Ramps	37.2	50.3	50.9
20	646	Monticello Dr	35.3	48.7	49.8
21	2157	Shirley Ln	44.4	49.9	49.1
22	3991	Atlanta Hwy	56.4	56.8	22.3
23	3070	Unnamed Rd	58.8	59.3	63.8
24	470	Wares Ferry Rd	48.2	44.5	61.2
25	998	Aster Dr / Twain Curve	14.0	33.8	60.4
26	917	Hackel Dr	44.4	41.5	58.8
27	1183	Lagoon Park Dr /	40.2	18.6	42.6
28	2006	Todd Rd	50.7	44.9	24.4
29	1105	Robinson Cir	59.3	54.1	61.3
30	1059	Lagoon Business	61.3	57.8	69.3
31	6293	Wetumpka Hwy	60.8	61.7	73.4
Totals	41789		43.4	41.6	39.9

Congestion Management Plan Update

Montgomery MPO

Study Name : East Blvd AM NB Study
 Study Date : 12/16/2013
 Page No. : 6

Detailed Statistics By Run

Total Delay (sec) by Section

East Blvd AM-NB-001 t
East Blvd AM-NB-002 t
East Blvd AM-NB-003 t

Node #	Length	Node Name	Run #1	Run #2	Run #3
1	0	Troy Hwy			
2	1480	Richard Rd	8	6	13
3	942	Christine Elizabeth Curve	1	0	3
4	628	Unnamed Rd	1	1	3
5	522	Calmar Dr	1	1	1
6	541	Executive Park Dr	0	0	0
7	729	Park Blvd	0	0	0
8	1052	Buckboard Rd	1	0	0
9	1417	Carriage Hills Dr	2	0	0
10	998	Hitching Post Ln	18	9	0
11	1246	Vaughn Rd	8	77	14
12	1639	Young Barn Rd	1	6	71
13	1181	Arbor Station Rd	1	0	1
14	1647	Haskell Dr	3	0	0
15	968	Woodmere Blvd	31	15	1
16	1094	Carmichael Rd	7	11	1
17	598	I-85 EB Ramps	1	1	1
18	619	I-85	1	1	0
19	593	I-85 WB Ramps	3	0	0
20	646	Monticello Dr	4	0	0
21	2157	Shirley Ln	6	2	3
22	3991	Atlanta Hwy	0	0	74
23	3070	Unnamed Rd	0	0	0
24	470	Wares Ferry Rd	0	2	0
25	998	Aster Dr / Twain Curve	36	7	0
26	917	Hackel Dr	2	3	0
27	1183	Lagoon Park Dr /	5	28	3
28	2006	Todd Rd	2	5	32
29	1105	Robinson Cir	0	0	0
30	1059	Lagoon Business	0	0	0
31	6293	Wetumpka Hwy	0	0	0
Totals	41789		143	175	221

Total Delay based on a Normal Speed of 55 MPH.

Congestion Management Plan Update

Montgomery MPO

Study Name : East Blvd AM NB Study
 Study Date : 12/16/2013
 Page No. : 7

Detailed Statistics By Run

Time <= 0 MPH by Section

East Blvd AM-NB-001 t
East Blvd AM-NB-002 t
East Blvd AM-NB-003 t

Node #	Length	Node Name	Run #1	Run #2	Run #3
1	0	Troy Hwy			
2	1480	Richard Rd	0	0	0
3	942	Christine Elizabeth Curve	0	0	0
4	628	Unnamed Rd	0	0	0
5	522	Calmar Dr	0	0	0
6	541	Executive Park Dr	0	0	0
7	729	Park Blvd	0	0	0
8	1052	Buckboard Rd	0	0	0
9	1417	Carriage Hills Dr	0	0	0
10	998	Hitching Post Ln	0	0	0
11	1246	Vaughn Rd	0	28	1
12	1639	Young Barn Rd	0	0	27
13	1181	Arbor Station Rd	0	0	0
14	1647	Haskell Dr	0	0	0
15	968	Woodmere Blvd	8	0	0
16	1094	Carmichael Rd	0	0	0
17	598	I-85 EB Ramps	0	0	0
18	619	I-85	0	0	0
19	593	I-85 WB Ramps	0	0	0
20	646	Monticello Dr	0	0	0
21	2157	Shirley Ln	0	0	0
22	3991	Atlanta Hwy	0	0	39
23	3070	Unnamed Rd	0	0	0
24	470	Wares Ferry Rd	0	0	0
25	998	Aster Dr / Twain Curve	10	0	0
26	917	Hackel Dr	0	0	0
27	1183	Lagoon Park Dr /	0	1	0
28	2006	Todd Rd	0	0	7
29	1105	Robinson Cir	0	0	0
30	1059	Lagoon Business	0	0	0
31	6293	Wetumpka Hwy	0	0	0
Totals	41789		18	29	74

Congestion Management Plan Update

Montgomery MPO

Study Name : East Blvd AM NB Study
 Study Date : 12/16/2013
 Page No. : 8

Detailed Statistics By Run

Time <= 40 MPH by Section

East Blvd AM-NB-001 t
East Blvd AM-NB-002 t
East Blvd AM-NB-003 t

Node #	Length	Node Name	Run #1	Run #2	Run #3
1	0	Troy Hwy			
2	1480	Richard Rd	17	15	26
3	942	Christine Elizabeth Curve	0	0	5
4	628	Unnamed Rd	0	0	4
5	522	Calmar Dr	0	0	0
6	541	Executive Park Dr	0	0	0
7	729	Park Blvd	0	0	0
8	1052	Buckboard Rd	3	0	0
9	1417	Carriage Hills Dr	5	0	0
10	998	Hitching Post Ln	20	14	0
11	1246	Vaughn Rd	12	84	17
12	1639	Young Barn Rd	0	8	72
13	1181	Arbor Station Rd	0	0	0
14	1647	Haskell Dr	5	0	0
15	968	Woodmere Blvd	35	20	0
16	1094	Carmichael Rd	16	24	0
17	598	I-85 EB Ramps	0	0	0
18	619	I-85	0	0	0
19	593	I-85 WB Ramps	10	0	0
20	646	Monticello Dr	13	0	0
21	2157	Shirley Ln	12	0	4
22	3991	Atlanta Hwy	0	0	82
23	3070	Unnamed Rd	0	0	0
24	470	Wares Ferry Rd	0	0	0
25	998	Aster Dr / Twain Curve	43	14	0
26	917	Hackel Dr	2	5	0
27	1183	Lagoon Park Dr /	7	36	7
28	2006	Todd Rd	0	5	38
29	1105	Robinson Cir	0	0	0
30	1059	Lagoon Business	0	0	0
31	6293	Wetumpka Hwy	0	0	0
Totals	41789		200	225	255

Congestion Management Plan Update

Montgomery MPO

Study Name : East Blvd AM NB Study
 Study Date : 12/16/2013
 Page No. : 9

Detailed Statistics By Run

Time <= 55 MPH by Section

East Blvd AM-NB-001 t
East Blvd AM-NB-002 t
East Blvd AM-NB-003 t

Node #	Length	Node Name	Run #1	Run #2	Run #3
1	0	Troy Hwy			
2	1480	Richard Rd	27	25	32
3	942	Christine Elizabeth Curve	13	1	15
4	628	Unnamed Rd	9	9	11
5	522	Calmar Dr	8	8	8
6	541	Executive Park Dr	7	7	7
7	729	Park Blvd	3	4	10
8	1052	Buckboard Rd	6	0	13
9	1417	Carriage Hills Dr	13	3	18
10	998	Hitching Post Ln	30	22	12
11	1246	Vaughn Rd	24	92	29
12	1639	Young Barn Rd	22	27	91
13	1181	Arbor Station Rd	16	14	16
14	1647	Haskell Dr	24	20	13
15	968	Woodmere Blvd	43	27	13
16	1094	Carmichael Rd	21	25	15
17	598	I-85 EB Ramps	9	8	9
18	619	I-85	9	9	8
19	593	I-85 WB Ramps	11	8	8
20	646	Monticello Dr	13	9	8
21	2157	Shirley Ln	33	29	22
22	3991	Atlanta Hwy	12	16	94
23	3070	Unnamed Rd	6	4	0
24	470	Wares Ferry Rd	6	8	0
25	998	Aster Dr / Twain Curve	49	20	0
26	917	Hackel Dr	14	15	0
27	1183	Lagoon Park Dr /	20	43	12
28	2006	Todd Rd	27	31	57
29	1105	Robinson Cir	1	7	1
30	1059	Lagoon Business	0	0	0
31	6293	Wetumpka Hwy	0	0	0
Totals	41789		476	491	522

Congestion Management Plan Update

Montgomery MPO

Study Name : East Blvd AM NB Study
 Study Date : 12/16/2013
 Page No. : 10

Speed/Distance Profiles of All Runs

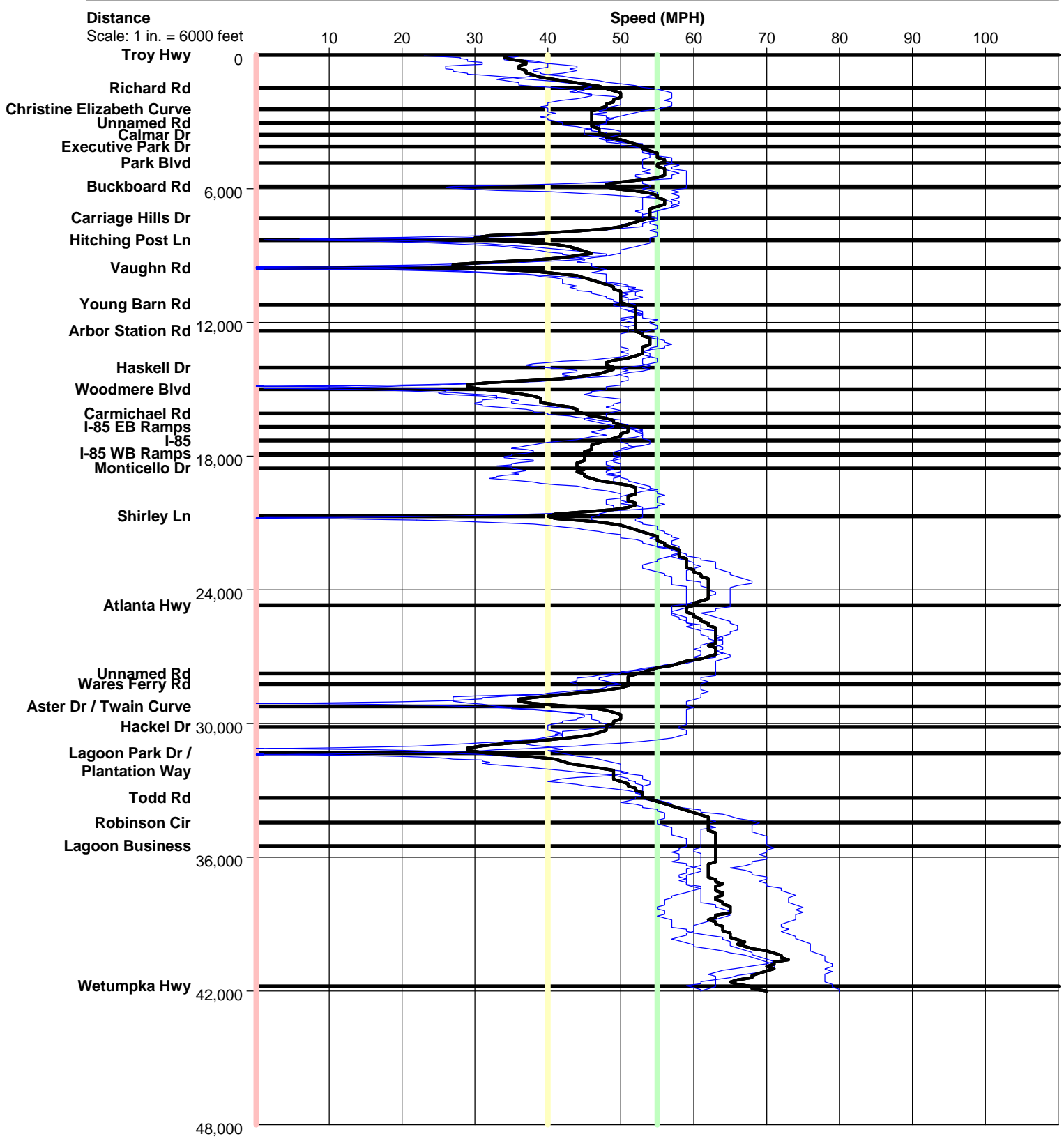

East Blvd AM NB

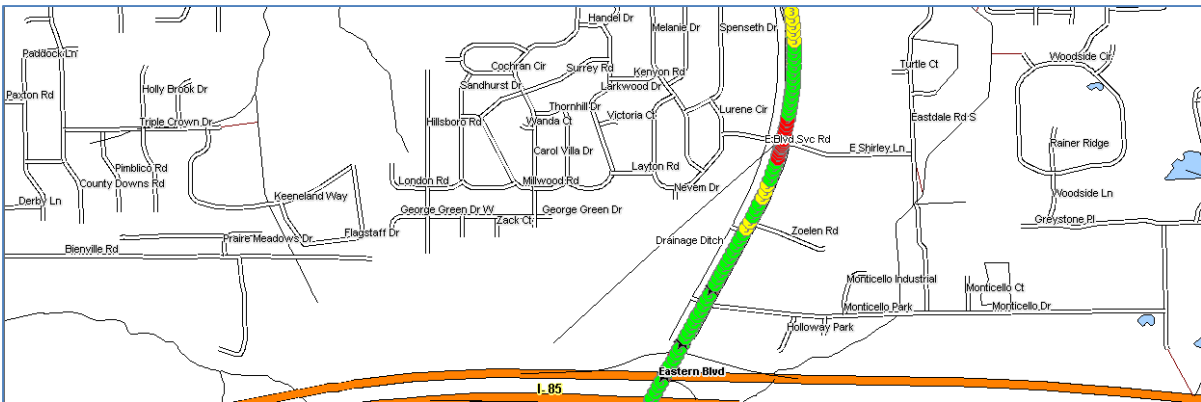
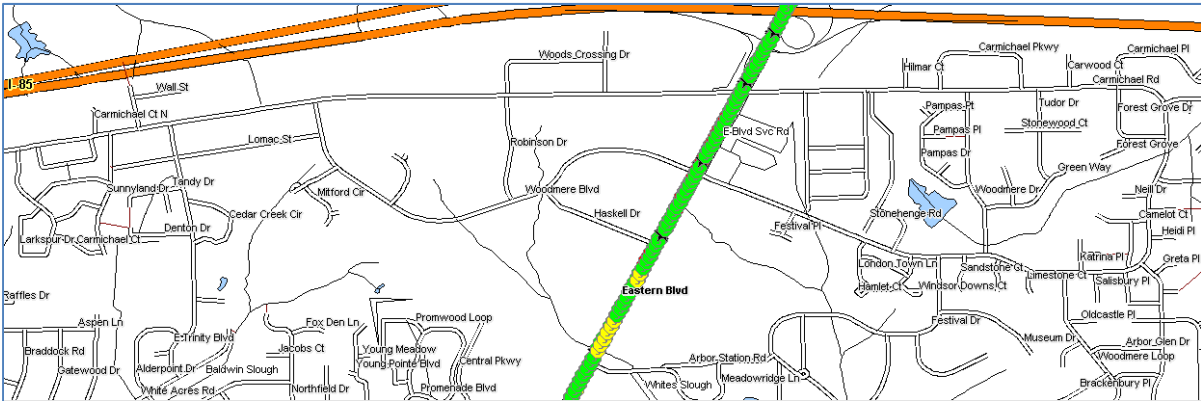
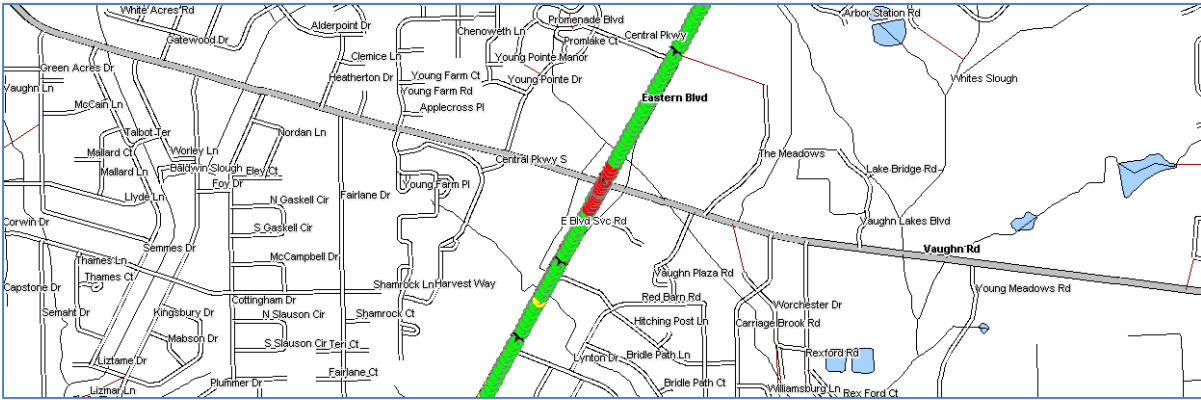
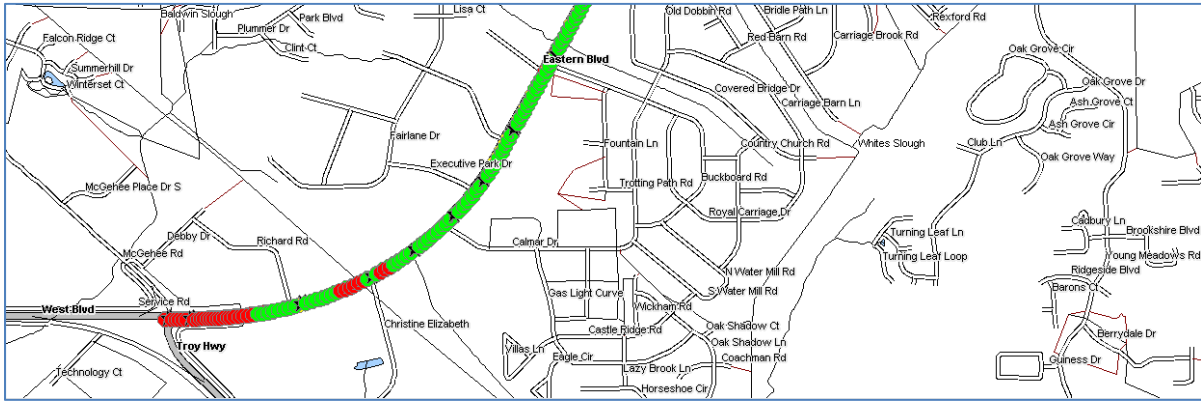

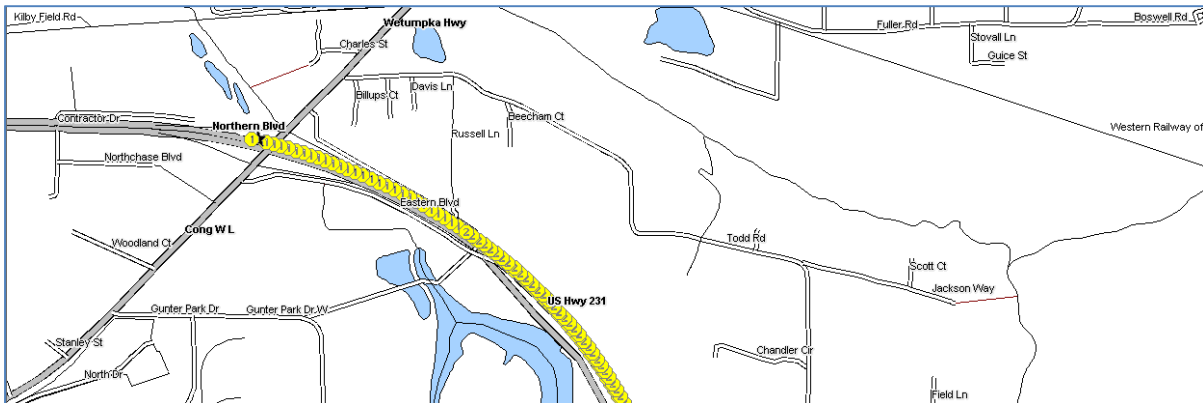
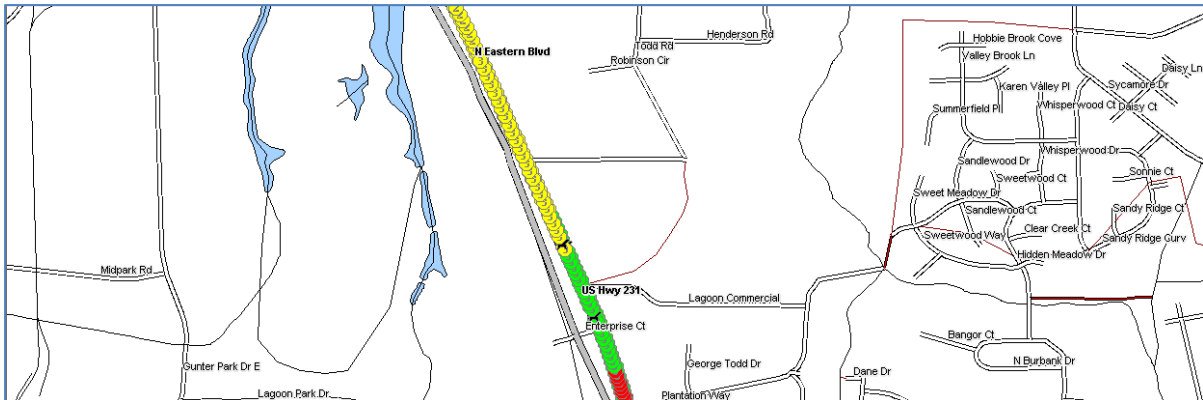
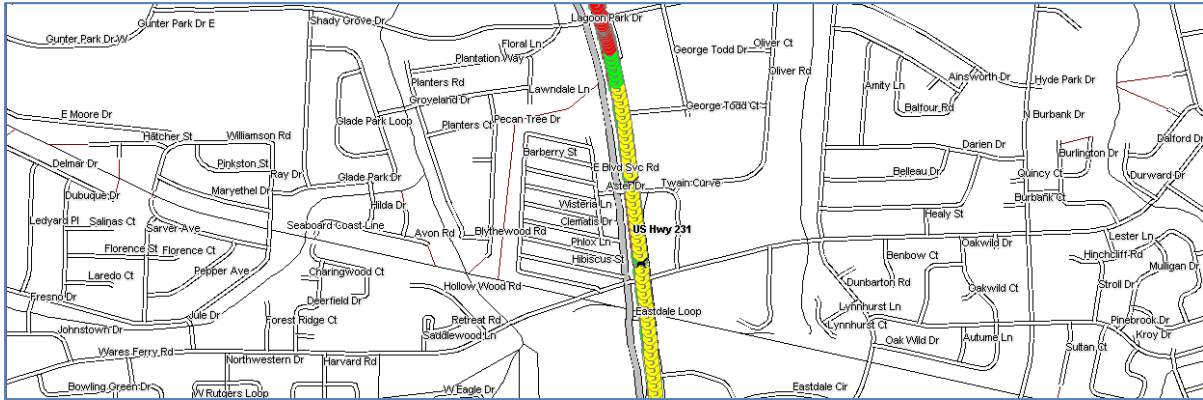
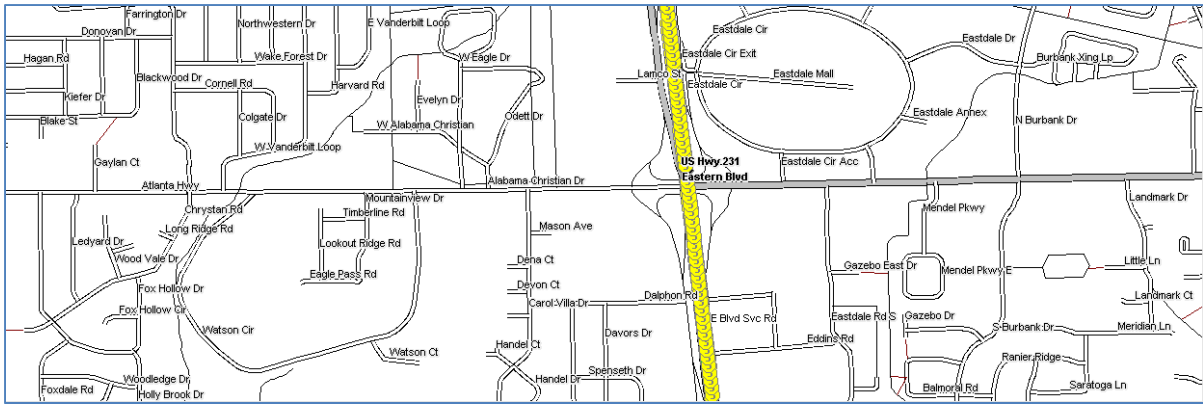

Color Code Speeds

■ Speed 1	0	To	40
■ Speed 2	40	To	55
■ Speed 3	55	To	99